



AVERY VITTORIA

Interior Design Portfolio

DESIGN STATEMENT

Passion • Adaptability • Wellness

My passion for design began at a young age with my chalk-drawn floor plans on the driveway and has only grown with time. As a kid, I was always designing new houses, cruise ships, RVs, et cetera. Throughout my life, I loved not only the **organizational and creative aspect**, but actually talking to different people and designing a house or space to fit their specific needs. I believe that a **space should reflect the people who inhabit it**; therefore, I try to always incorporate any and every unique aspect of the client or company's life into the space I design for them. This gives clients a sense of comfort, changing the way they feel about coming home, or to work, or whatever the space may be.

I have always been inspired by the world and the people around me, and I hope to incorporate the **uniqueness** of each person and place into my designs. I am especially intrigued by the concepts of universal design and design for well-being. Every one of us has different abilities, and those should be celebrated, not minimally accommodated for. Spaces should be adaptable for each person that may use it. In my own designs, I aim to go above and beyond to provide spaces for all types of people. A large part of **providing for all ages and abilities** is creating a space that also supports the idea of well-being. This often includes sustainability, bringing the outside in, and encouraging the people to continue to practice these ideas of wellness; all things I intend to include in my designs.

I truly believe that design can have an immense impact on the lives of the people immersed in the spaces, and I strive to make that impact a good one. I hope to **better the lives of others** through design and find a way to help people discover or display their own passion through my **passion**.



06 Beyond the Pages
Senior Living Design

18 Studio C
Cruise Ship Design

28 Enerspace Co-Working
Workplace Design

38 Foster Records
Retail Design

48 Additional Designs
Renderings & Models

**TABLE OF
CONTENTS**



BEYOND THE PAGES

Senior Living Design

Location: Dunwoody, GA
Date: Winter 2019

A home for seniors to share their legacies.

Beyond the Pages is a **collaborative Independent Living Community** focused on giving seniors a chance to **share their legacy** with other members of the community in many different ways. The space will encourage residents to get out of their shell, inspiring them to **find meaning in their own lives**. By allowing the seniors to share their legacy, they are given a chance to share knowledge they learned from their career, tell stories about their families, and enjoy new experiences with other generations ranging from pre-schoolers to young adults. These things, in turn, give the residents a **sense of purpose**, helping with isolation, loneliness, and **overall wellbeing**.

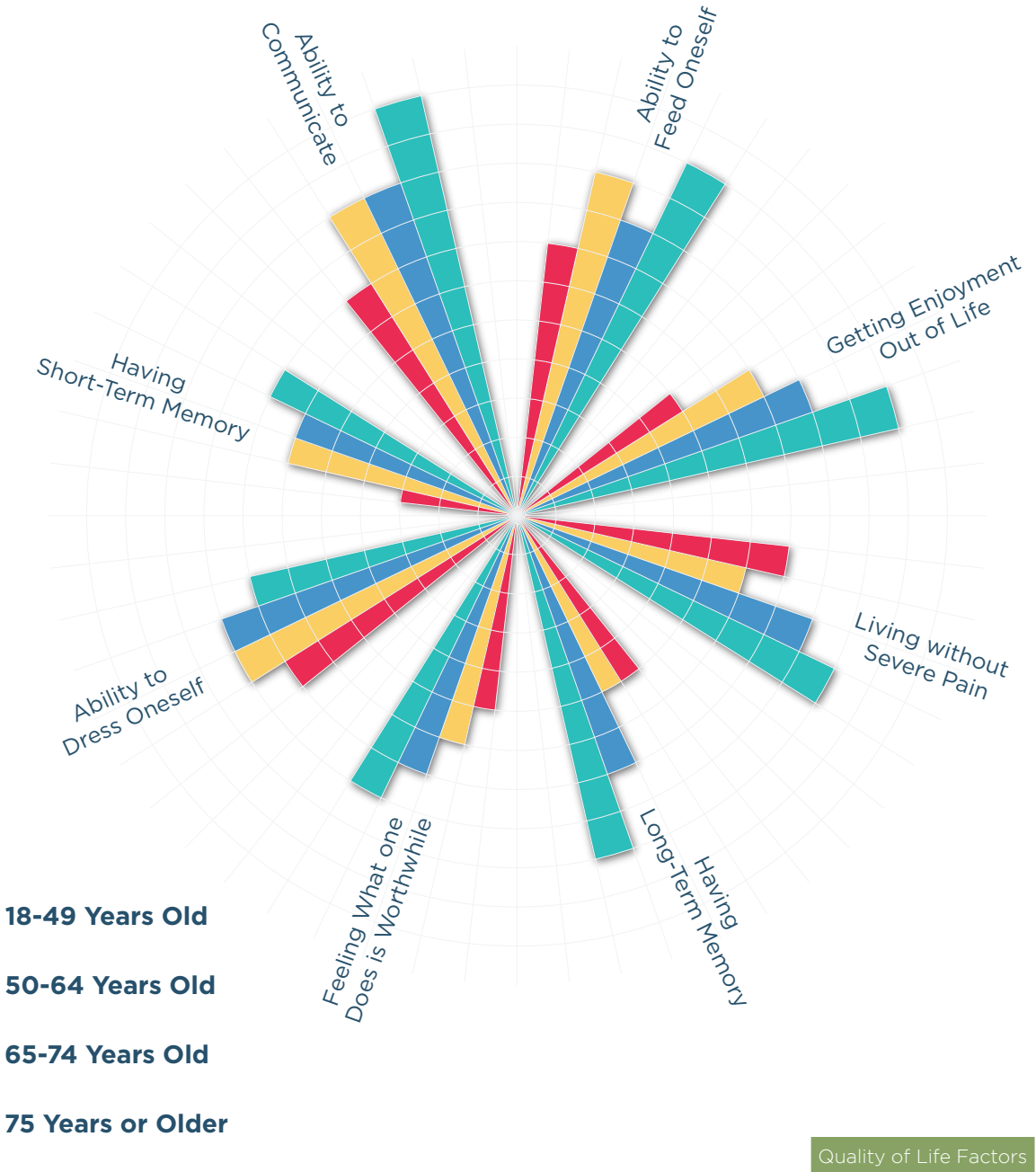
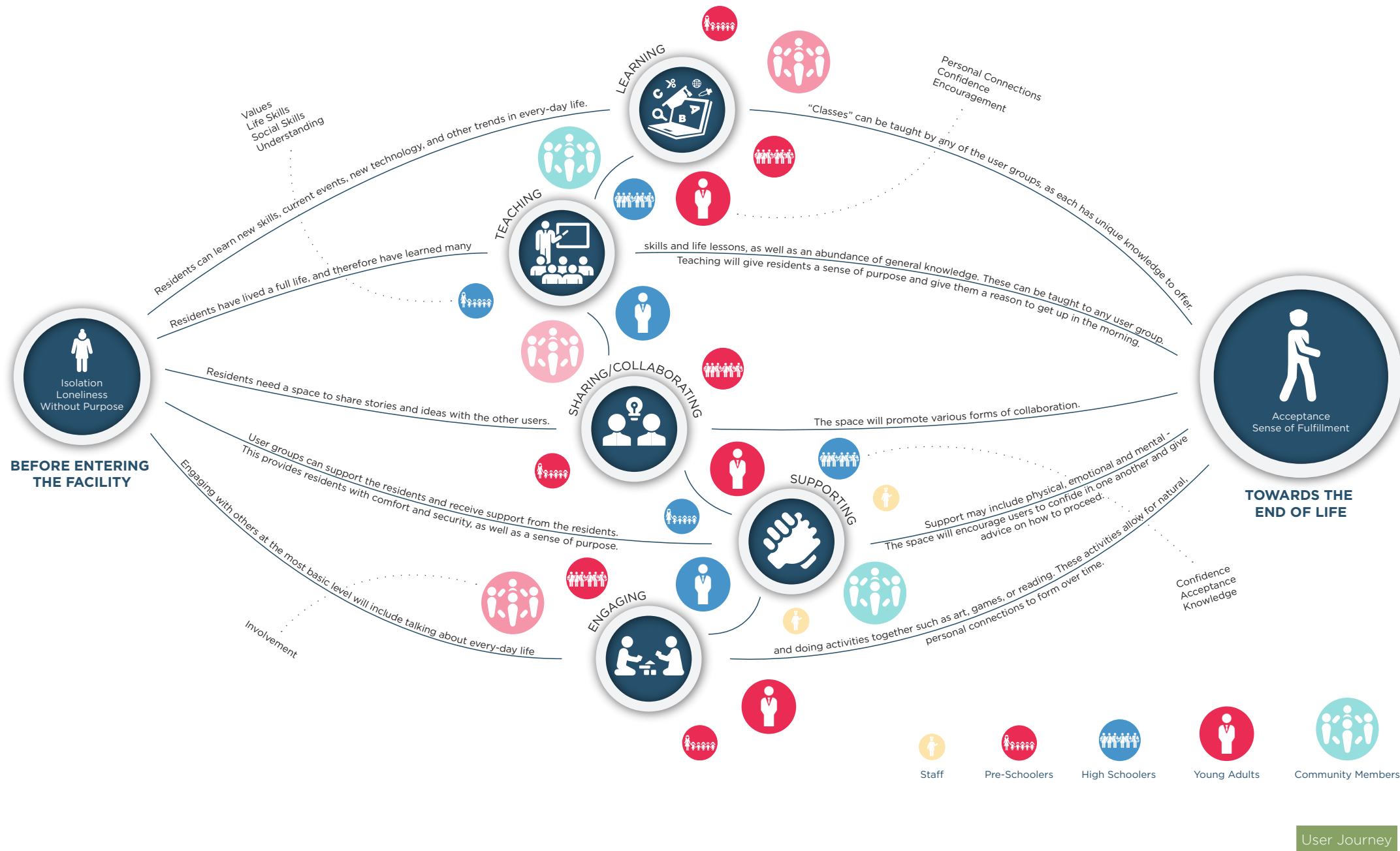

Project Goals

People are generally motivated by five main things: career, love, family, new experiences, and **legacy**. The focus of this particular space is to allow seniors to share their legacy with outside community members in order to reincorporate these motivation factors into their lives. Seniors are able to share their legacy through spaces that encourage **learning, teaching, sharing & collaborating, supporting, and engaging**.

Concept | Beyond the Pages

The idea of legacy is not just the stories being shared, but the impact those stories have on others.

There are many bits and pieces in a book that must work together to create the full story; however, what truly matters is what comes after. Every good story has a lasting impact; all the memories, knowledge, and lessons are a part of a bigger picture. Stories **engage** us with the first line, they **immerse** us with enthralling stories, and they **inspire** us with morals and new ideas.

Beyond the Pages will encourage its residents and visiting community members to not only share their stories, but to **change each others lives** and come out with a newfound acceptance and appreciation.

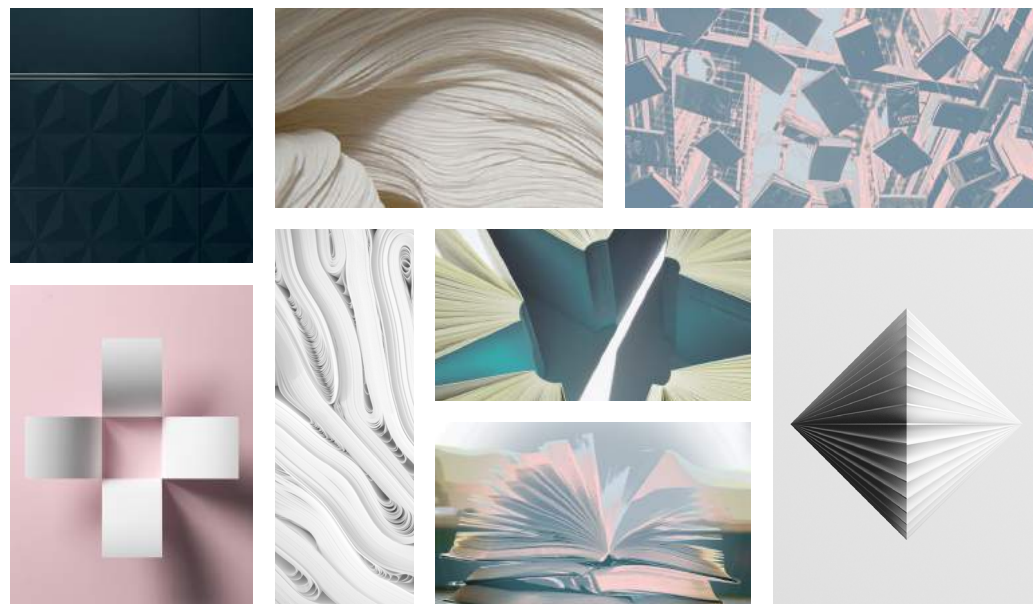

Entry



Concept Application

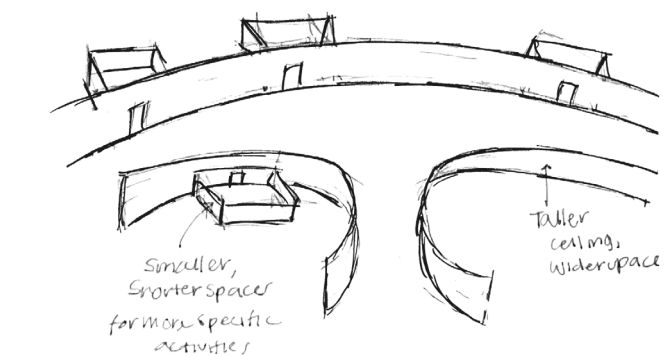

Concept Application



Reception

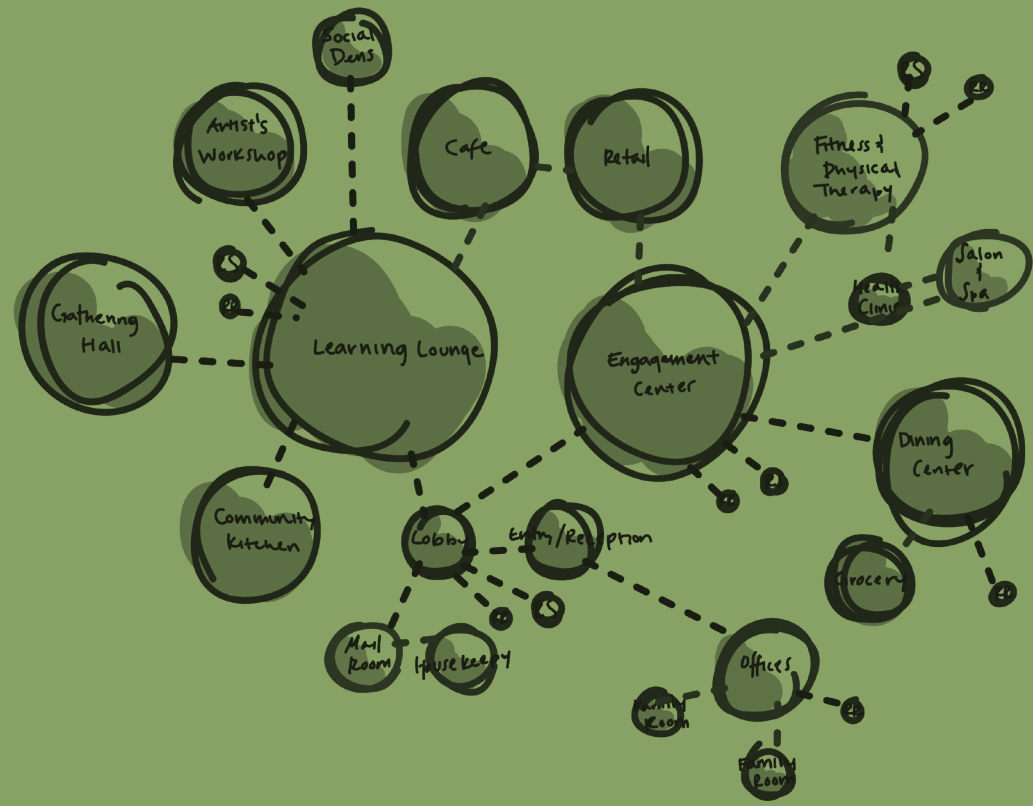

Bubble Diagram

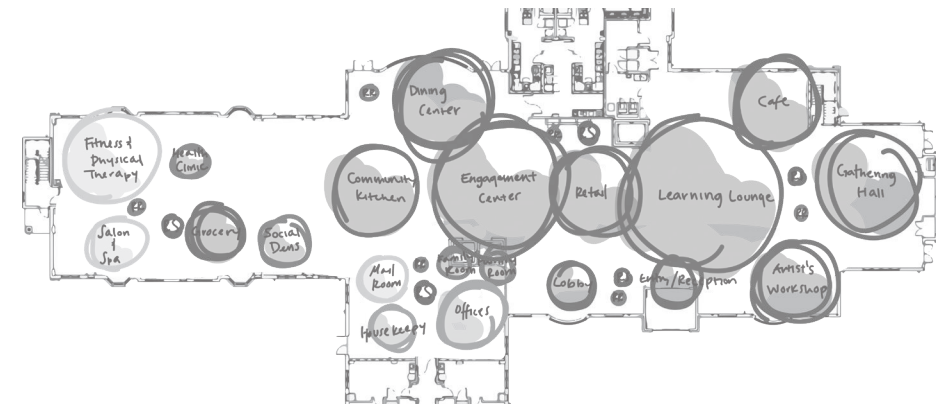

Bubble Diagram

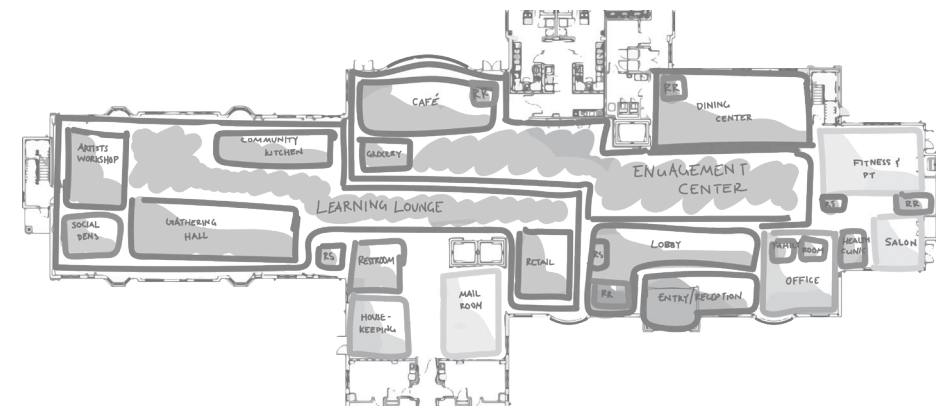

Block Diagram

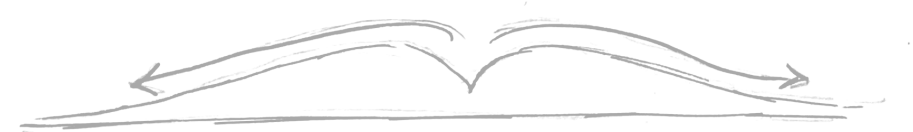

Flow of Space

- 1 Cafe
- 2 Community Kitchen
- 3 Social Den
- 4 Learning Lounge
- 5 Gathering Hall
- 6 Retail
- 7 Technology Corner
- 8 Restrooms
- 9 Children's Area
- 10 Elevator Equipment
- 11 Mail Room
- 12 Housekeeping
- 13 Engagement Center
- 14 Artist's Workshop
- 15 Entry
- 16 Reception
- 17 Dining Center
- 18 Offices
- 19 Gym
- 20 Salon

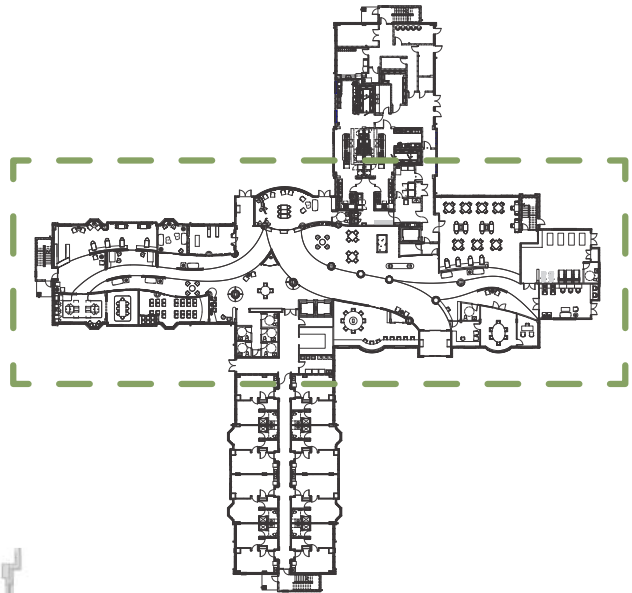

Floor Plan



Learning Lounge

IMMERSE : Spaces will have sections or "pockets" for activities to keep people attention for each key experience

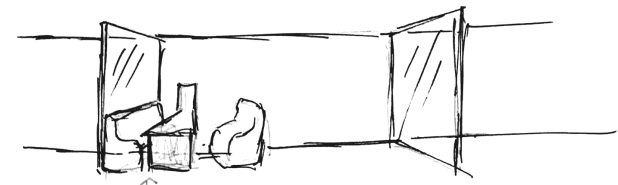

Grouped seating w/ separating wall

Concept Application

Separation Wall for Privacy

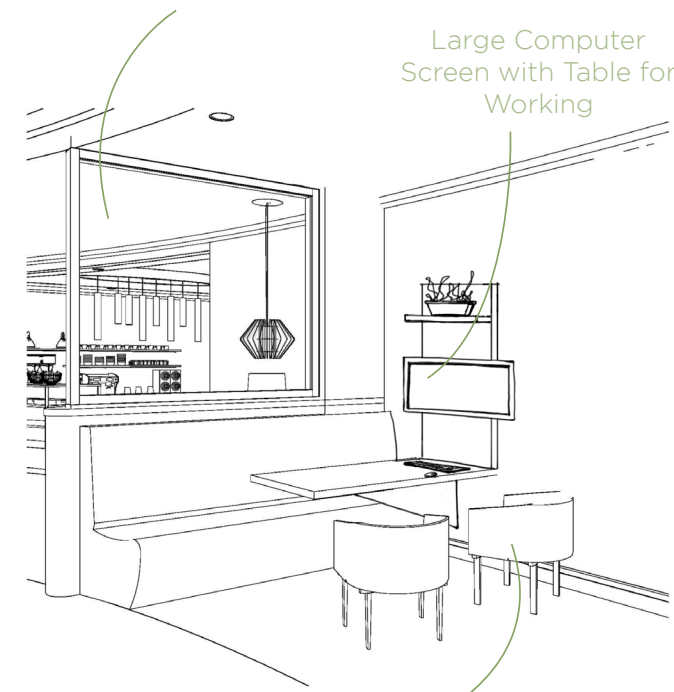

Large Computer Screen with Table for Working

Seating for One-on-One Interactions

Collab. Station

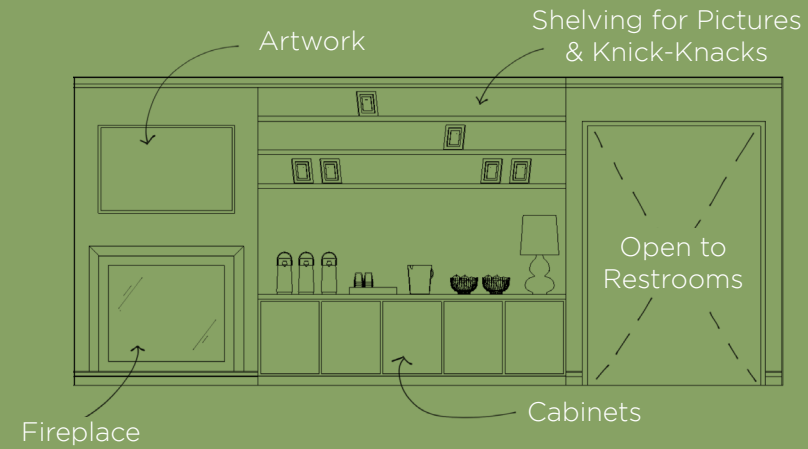

Fireplace

Learning Lounge Refreshment Station



Engagement Center

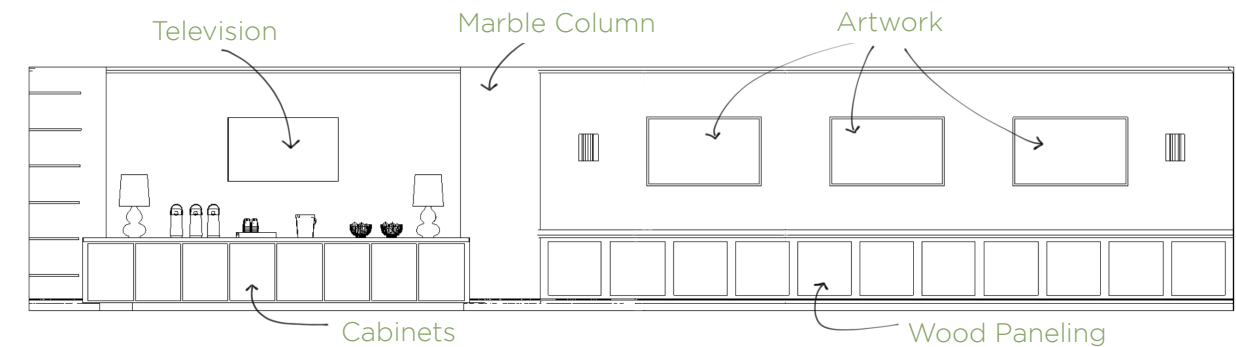

Television

Marble Column

Artwork

Cabinets

Wood Paneling

Engagement Center Refreshment Station

Beyond the Pages Amenities

Beyond the pages offers residents and guests many different spaces for **sharing their legacy**. The main pathways allow for intuitive wayfinding throughout the space. In the **Learning Lounge**, residents and visitors may sit together to share stories or knowledge with various easy-to-use technology options. The **Engagement Center** has game tables, a pool table, a television, and a shelf full of books and games.

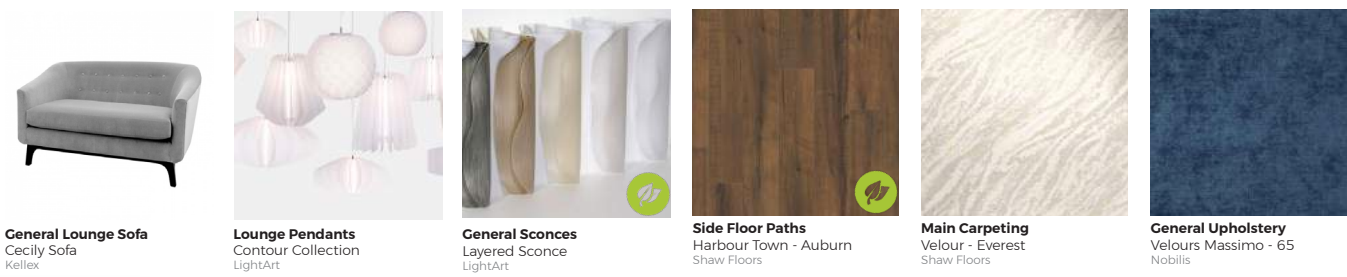

General Lounge Sofa
Cecily Sofa
Kelltex

Lounge Pendants
Contour Collection
LightArt

General Sconces
Layered Sconce
LightArt

Side Floor Paths
Harbour Town - Auburn
Shaw Floors

Main Carpeting
Velour - Everest
Shaw Floors

General Upholstery
Velours Massimo - 65
Nobilis



Children's Area



Cafe

Beyond the Pages Amenities

The **Children's Area** allows residents to spend time with family members who are young children, along with pre-school student's from the neighboring pre-schools. In the **Community Kitchen**, residents have an opportunity to share family recipes or teach guests cooking techniques they have learned throughout their lives.

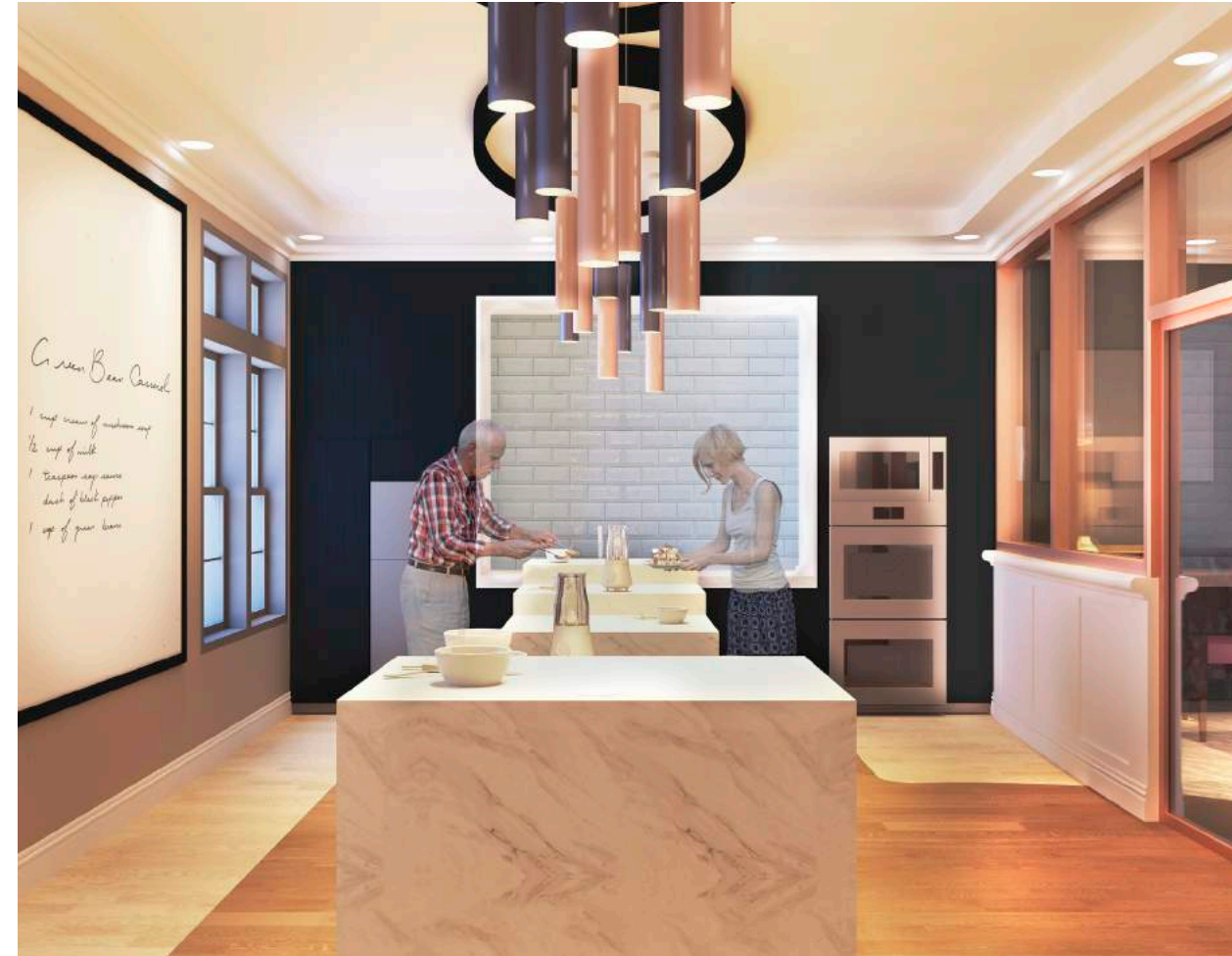

Community Kitchen



Pendant Lighting
Monae LED Mini Pendant
Kuzco Lighting



Feature Lighting
Pendant Tube
Intra Lighting

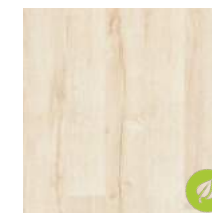

Kitchen Flooring
High Road - Crisp Linen
Shaw Floors



Counter-Tops
Quartz - Salar
Wilsonart



Cabinets
Beech (Stained Blue)
National Wallcovering

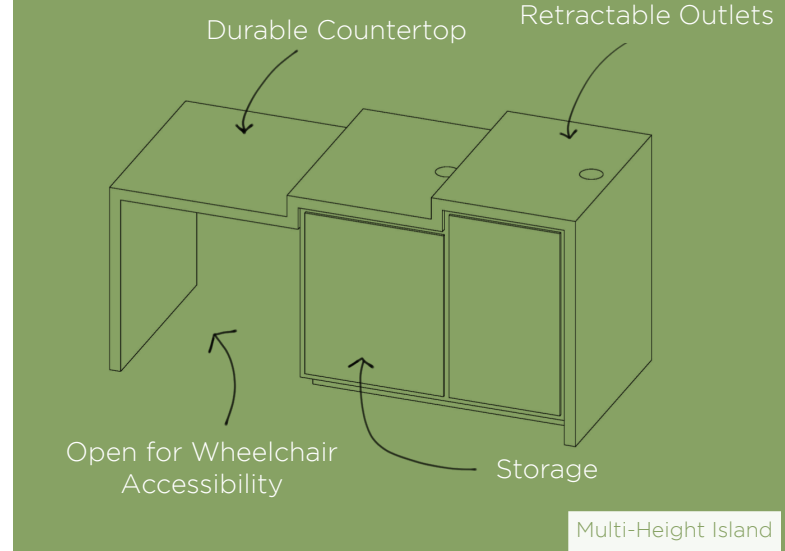

Community Kitchen Seating



STUDIO C

Cruise Ship Design

Location: Cruise Ship

Date: Spring 2018

A room to embrace your inner artist.

Visitors can experience a **wide-variety of creative outlets** with this nature-inspired art space designed with well-being in mind. It is a space to relax and let your curiosity take over. The room is complete with many large-scale and small-scale art forms along with a Virtual Reality space and **special considerations for those on the autism spectrum.**

Concept | Serene Curiosity

Serene Curiosity stems from the idea that the natural world can be soothing and fascinating all at the same time. The **delicate intricacies** of nature create unique **patterns** and **layers** stimulating curiosity and reflection. There is an obvious connection between art and nature, as many of the most beautiful things in life are created naturally; it is our **innate curiosity** that allows us to appreciate this beauty.

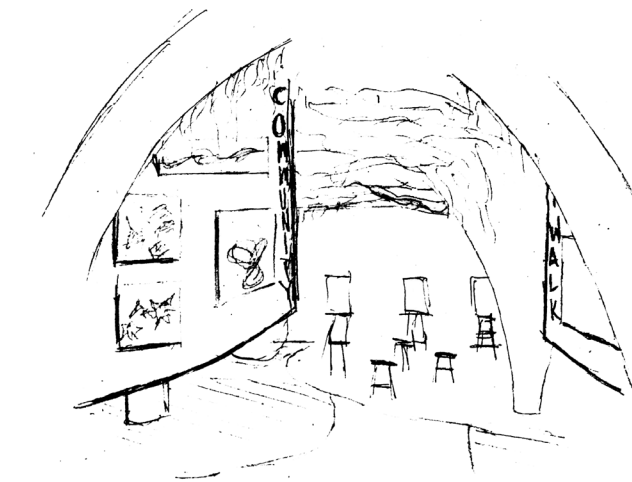

Art Walk

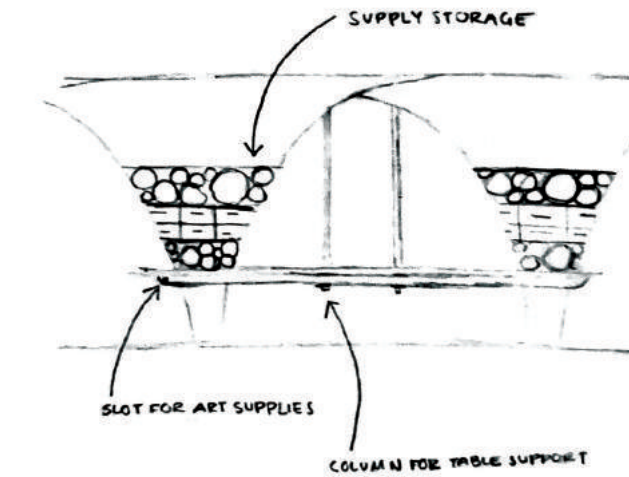

Columns

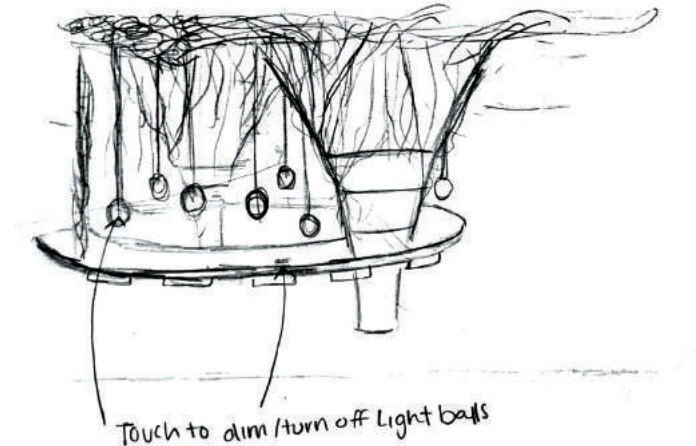
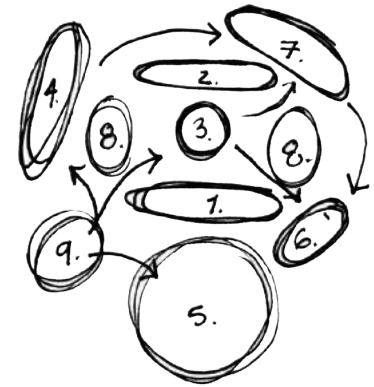

Table Lighting



Entry and Community Art Walk

SERENE
CURIOSITY



- 1: Art Wall
- 2: Digital Wall
- 3: Teaching Table
- 4: Chalk wall
- 5: Kids Area
- 6: (lay?)
- 7: Floor Art?
- 8: Seating
- 9: Entry

Bubble Diagram

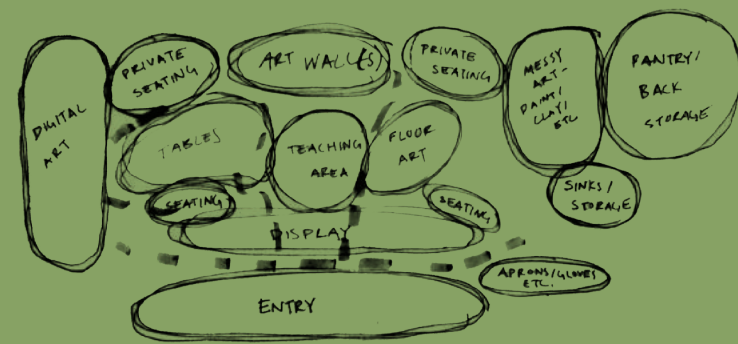

Bubble Diagram

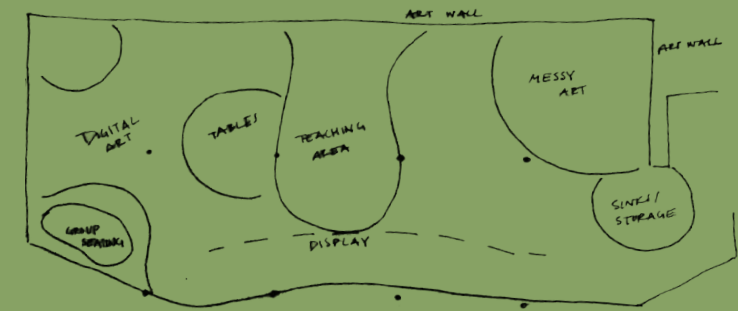

Schematic Plan

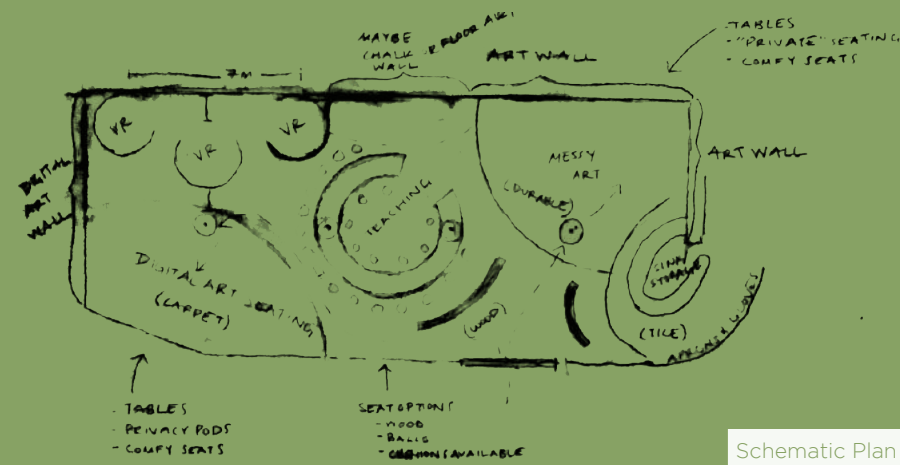

Schematic Plan

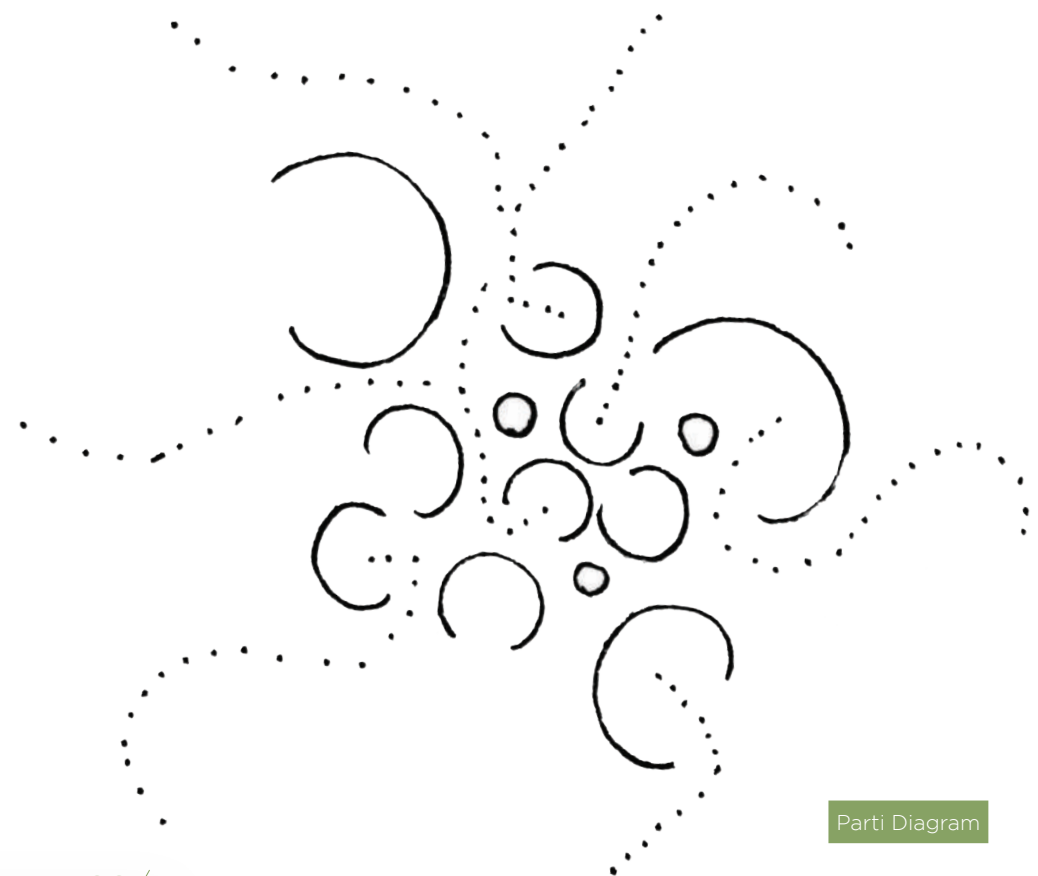

Parti Diagram

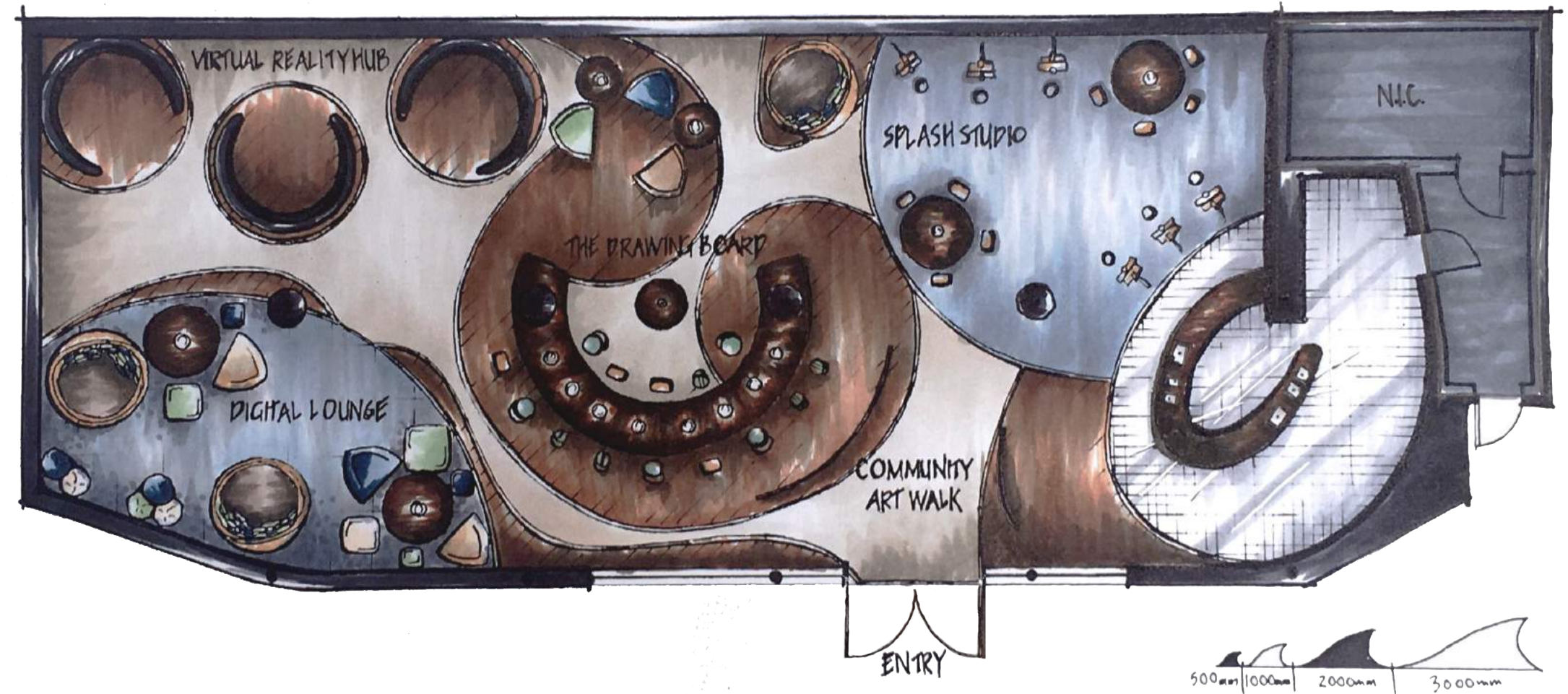

Floor Plan

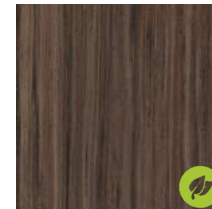

Main Flooring
Marmoleum Striato Original
Forbo Flooring System

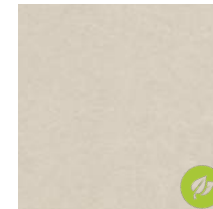

Path Flooring
Marmoleum Real
Forbo Flooring System



Digital Lounge Flooring
Soft Embrace - Blue Lagoon
Godfrey Hirst



Splash Studio Flooring
Marmoleum Fresco
Forbo Flooring Systems



Sink Area Flooring
Cascade VT.323P - Marble Look
Eco Friendly Tiles

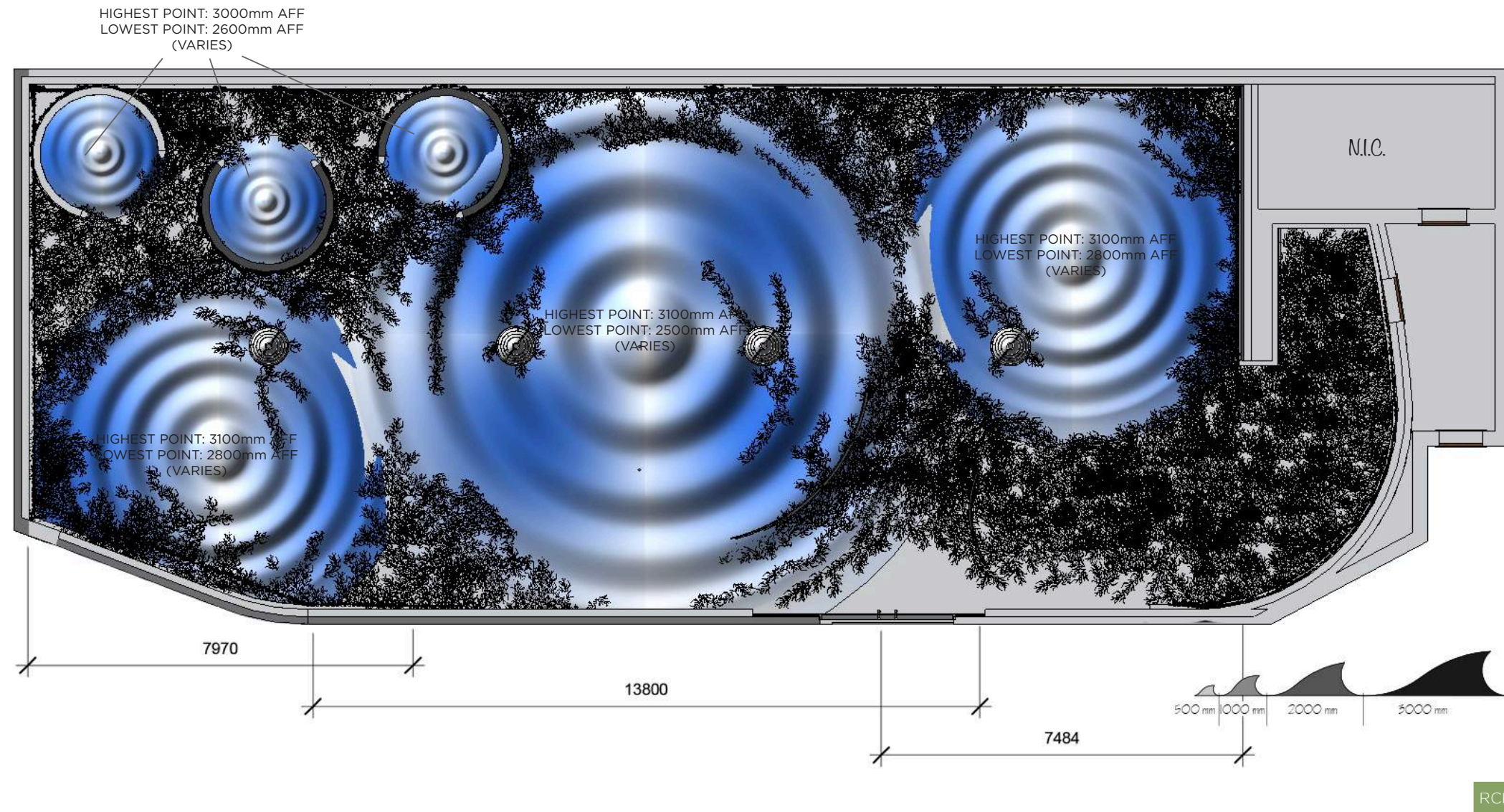

Studio C Amenities

Studio C consists of five unique spaces for creating: the **Splash Studio** for painting, the **Virtual Reality Hub** for doing virtual reality art, the **Digital Lounge** for digital art on tablets, **The Drawing Board** for demonstrations or workshops when available, or general, seated art, and finally, the **Community Art Walk** for displaying the art made here. The autism considerations include intuitive wayfinding, balance of public versus private spaces, natural textures and materials, dim lighting and good acoustics, and many options to **cater to individual sensory needs**.



General Seating
Coconut Chair
Vitra



Table Seating
Ballo
Humanscale



Table Seating
K2 Seat
Jensen Plus



Table Seating
Shell Seating
Karl Andersson & Soner



Splash Studio



Virtual Reality Hub



Digital Lounge

Retractable Center Table for Teaching

Pillars with Supply Drawers

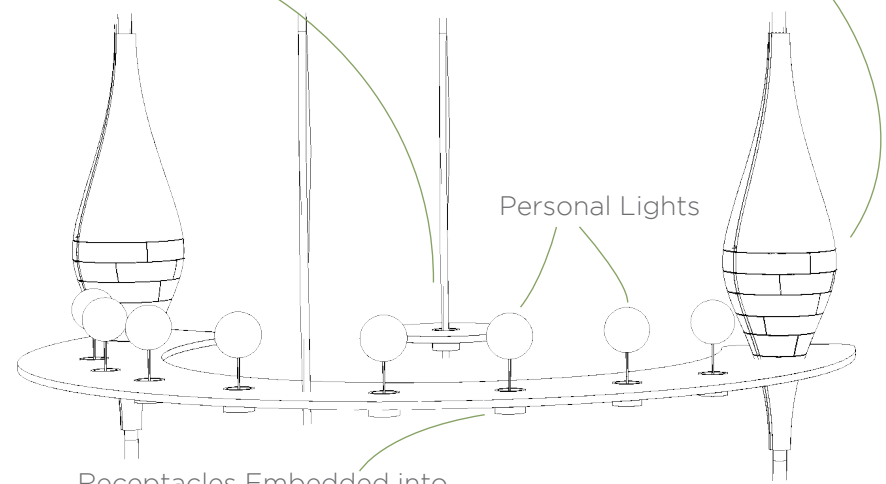

Receptacles Embedded into Table for Art Utensils

Personal Lights

Center Table

Curved Back and Sides Create a Semi-Private Space

Many Pillows for Maximum Comfort

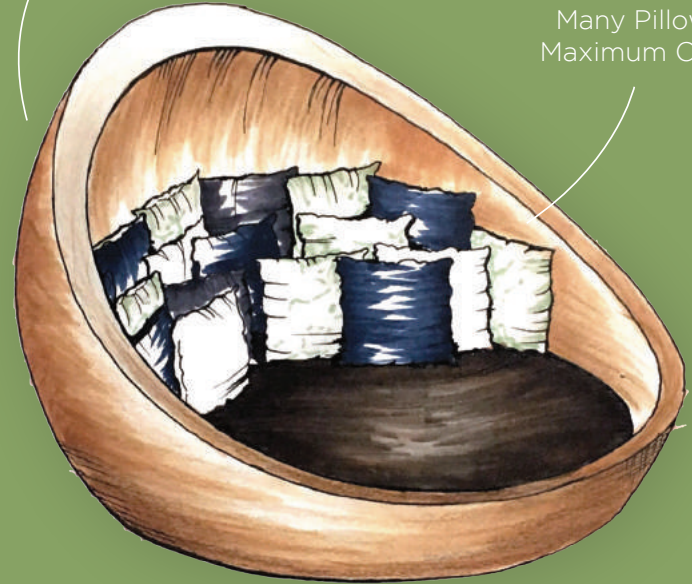

Large Enough for Two to Three People

Nest Seating



Entire Space



ENERSPACE

Workplace Design

Location: Savannah, GA

Date: Winter 2018

An adaptable office for workplace wellness.

Enerspace invites anyone from big businesses to individuals to rent out short-term or long-term office space in a **flexible, wellness focused workplace**. The office provides workers with many **different working preferences** including ergonomic office chairs, balance chairs, standing desks, and group seating. There are also conference rooms, a studio, and large **dining and relaxation spaces**.

Concept | Involuntary Fascination

Involuntary fascination means **subconsciously triggering the mind** into feeling a certain way or wanting to know more. Things that are **subtle** and **simple**, yet at the same time **bold**, attract the brain's attention and create a sense of involuntary fascination, something so powerful, you have to keep looking, or keep coming back.



Reception

Project Goals

This project focused on **sustainability** and the **environment**. This is promoted through sustainable materials and furniture, as well as the incorporation of nature (i.e. **moss walls** and **daylighting**) and biophilic design (i.e. natural patterns and shapes) into the space.

INVOLUNTARY
FASCINATION

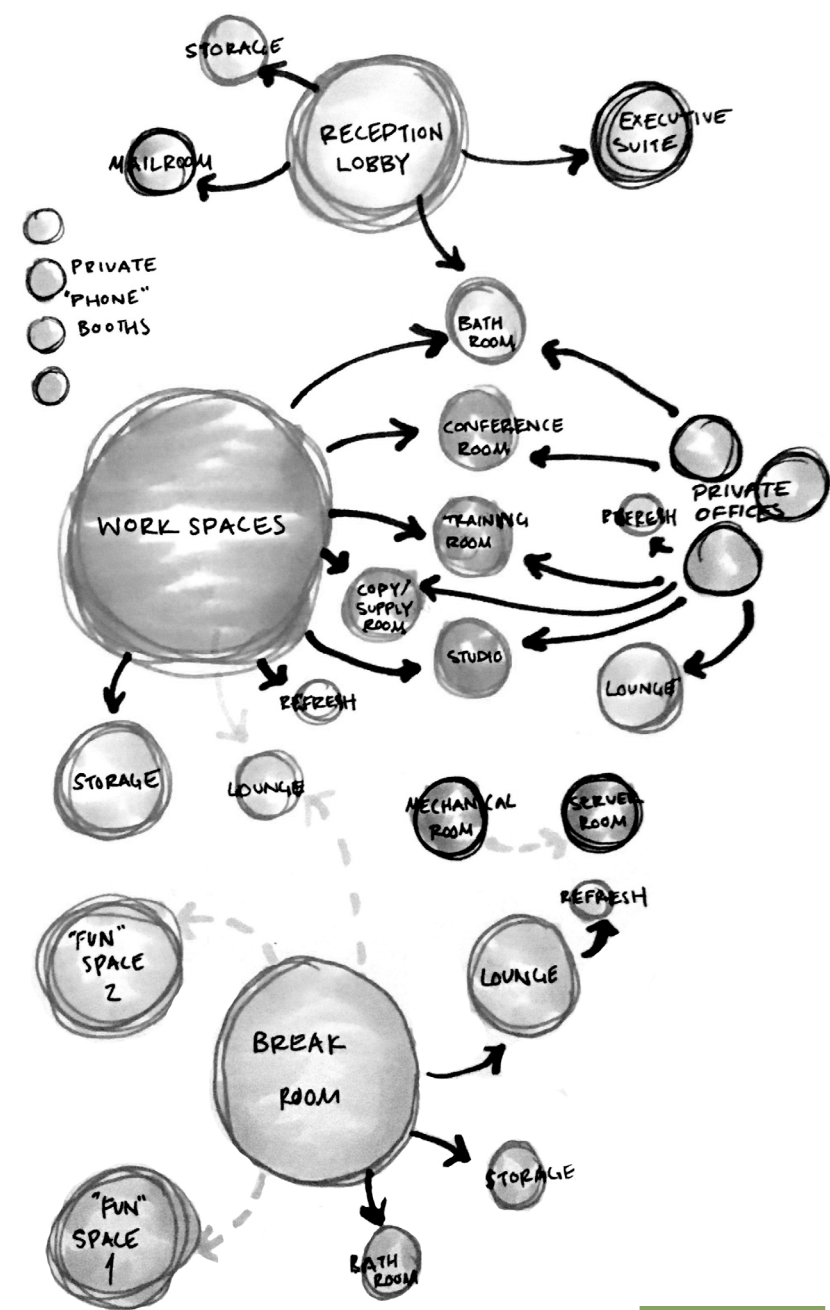

Bubble Diagram

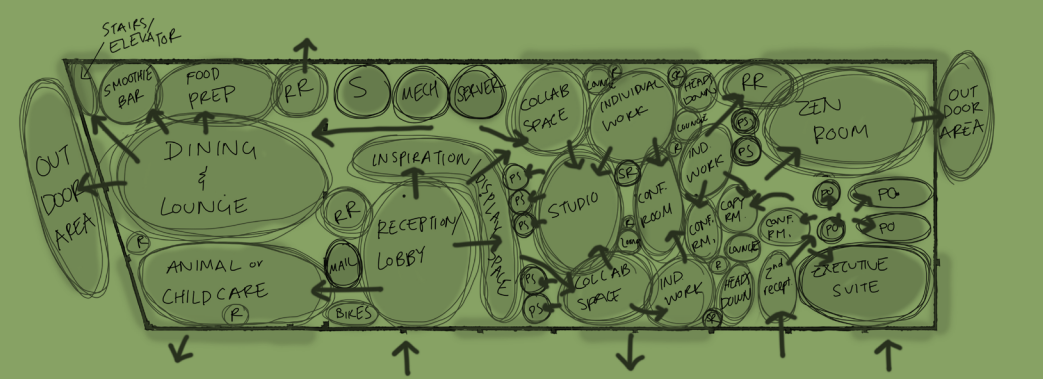

Bubble Diagram

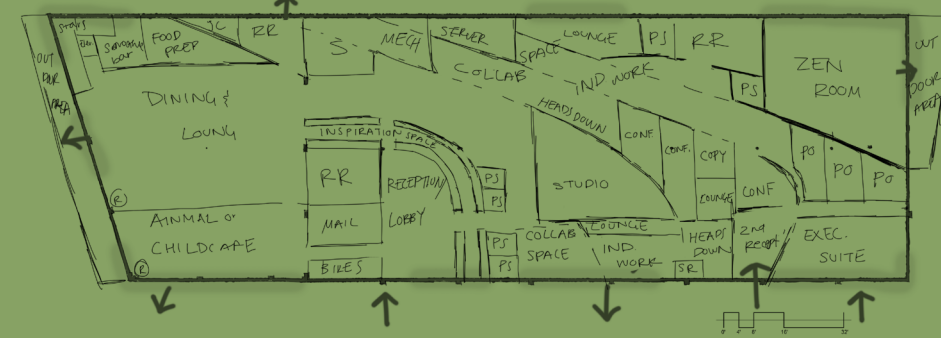

Bubble Diagram

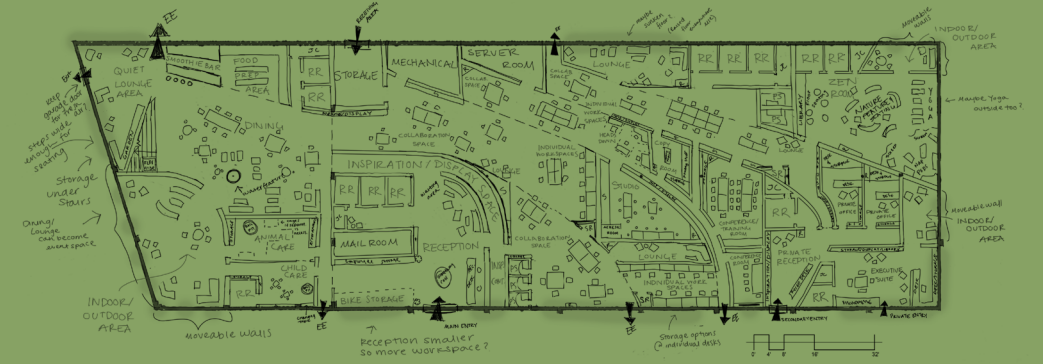

Bubble Diagram



- 1 Smoothie Bar
- 2 Food Prep
- 3 Dining/Lounge
- 4 Outdoor Area
- 5 Animal Care
- 6 Child Care
- 7 Restrooms
- 8 Server Room
- 9 Bike Storage
- 10 Mechanical Room
- 11 Inspiration Space
- 12 Reception
- 13 Main Entry
- 14 Storage
- 15 Open Workspace
- 16 Phone Call Rooms
- 17 Lounge
- 18 Copy/Supply Room
- 19 Studio
- 20 Stress Relief
- 21 Changing Room
- 22 Conference Room
- 23 Zen Room
- 24 Private Office
- 25 Secondary Reception
- 26 Executive Suite
- 27 Dining & Lounge

Floor Plan



Open Workspace

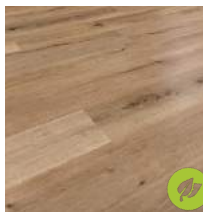

Main Flooring
Aged Hickory Vinyl Plank
Calli Bamboo

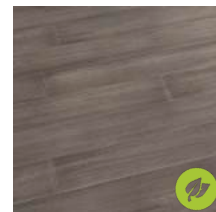

Accent Flooring
Engineered Bamboo
Calli Bamboo

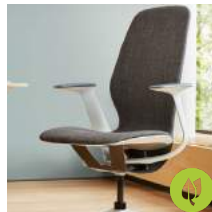

Open Desks & Private Offices
STLQ Desk Chair
SteelCase



Collaboration Seating
Saiba Multitask Chair
Herman Miller



Studio & Collaboration Spaces
Ballo
Humanscale



Open Workspaces
Tour Workspace
SteelCase

Sitting VS... Standing

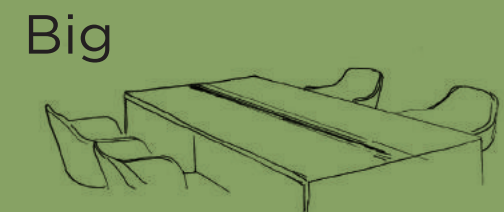

VS... Small



Adaptability



Executive Suite

Executive Suite

The personal **executive suite** allows a worker who needs his or her own space to be able to work privately, have small meetings, make food, or relax outside with the indoor/outdoor area. The space offers **plenty of storage** options as well as a private bathroom. Designed with the concept in mind, the custom desk and cabinet system is an **intriguing architectural feature** complete with a moss wall and even a view of the Savannah Talmadge Bridge outside.



Executive Suite Floor Plan



Mezzanine

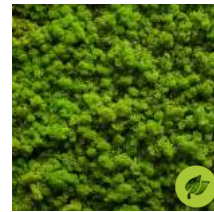

Green Walls
Nordik Moss Wall
Benholm



Accent Wall
ISO Pattern - Dye
Dirtt



Collaboration & Conference
Campfire Big Table w/Trough
Steelcase



Lounge Seating
Saiba Lounge Chair
Herman Miller



Dining Area
Scoop Stool
Steelcase

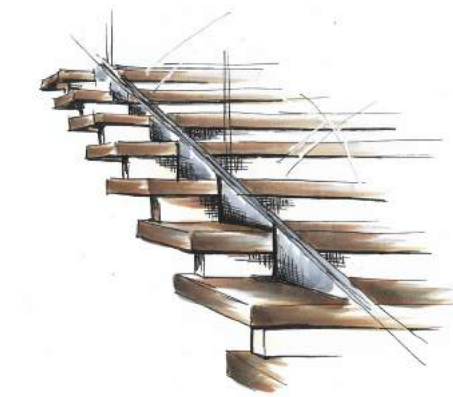

Stair Detail



Food Prep

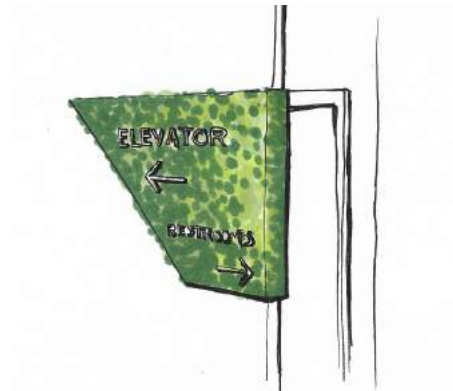

Wayfinding

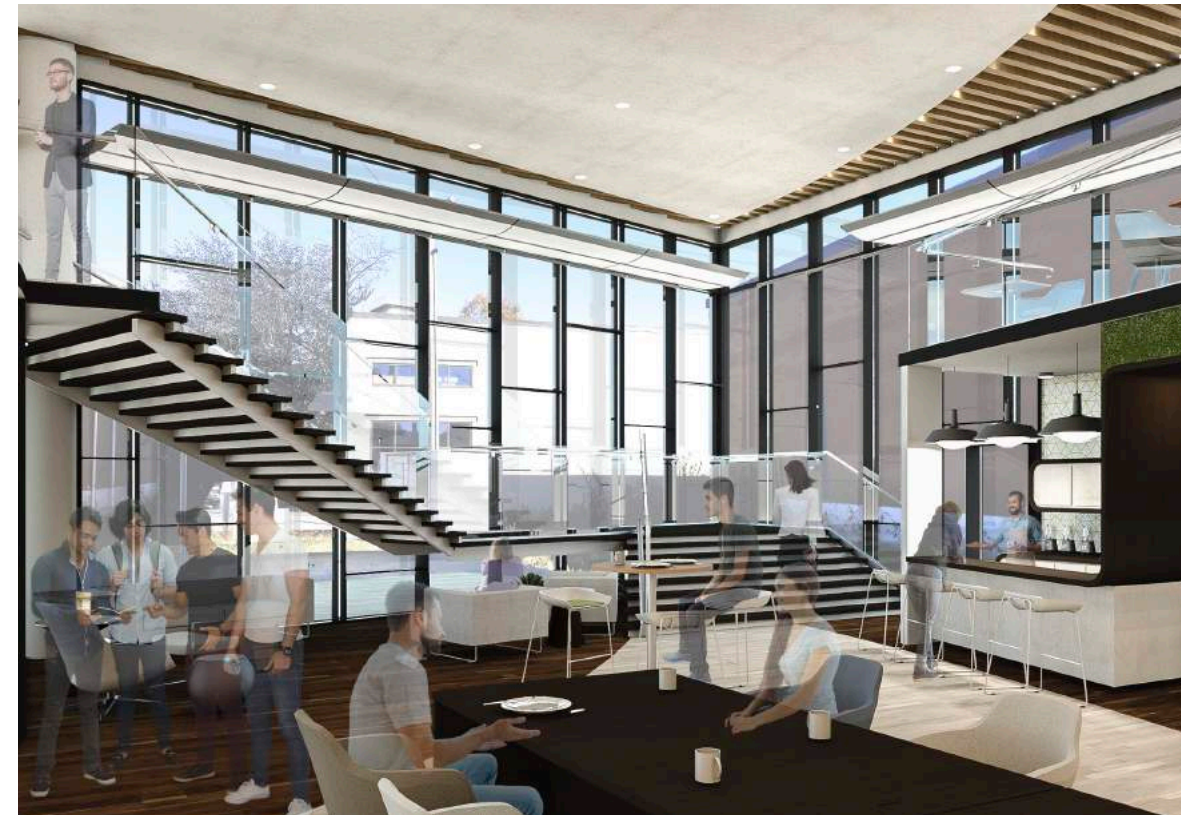

Dining/Break Area



Dining/Break Area Section

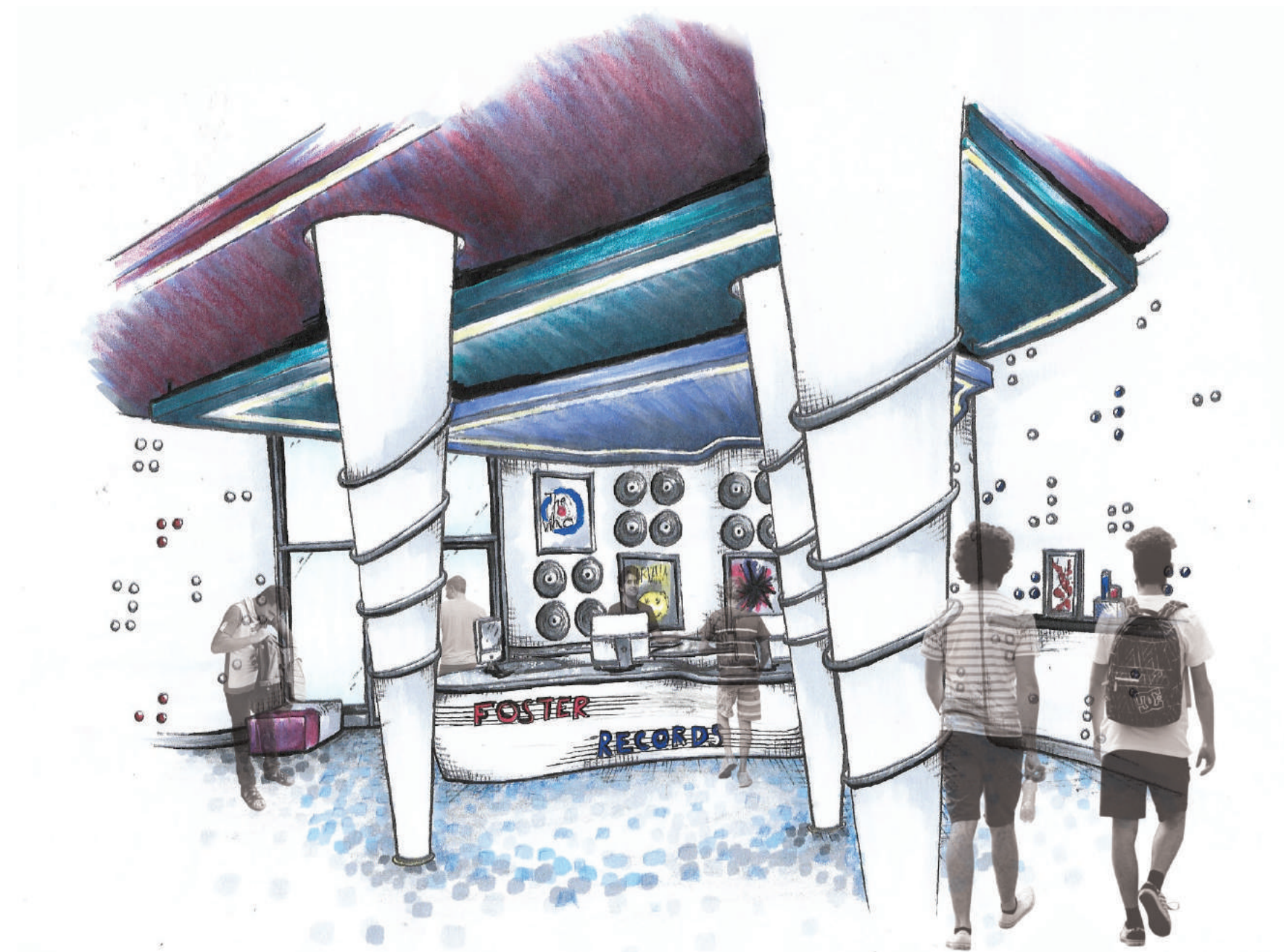

FOSTER RECORDS

Retail Design

Location: Miami, FL

Date: Fall 2017

A record shop to inspire all ages and abilities.

Designed not only for buying records, Foster Records is also a place to hang out, meet new people, and **become inspired**. The shop provides many different areas for **getting comfortable** including, open seating, large spherical pods in the wall, and **private listening studios with personal record players**.

Concept | The World Through a Child's Eyes

The concept focuses on the way children see and interact with the world around them. This includes **bright, solid colors**, many **tactile** things to interact with, pods to climb into, and an overall sense of **excitement and exploration**.

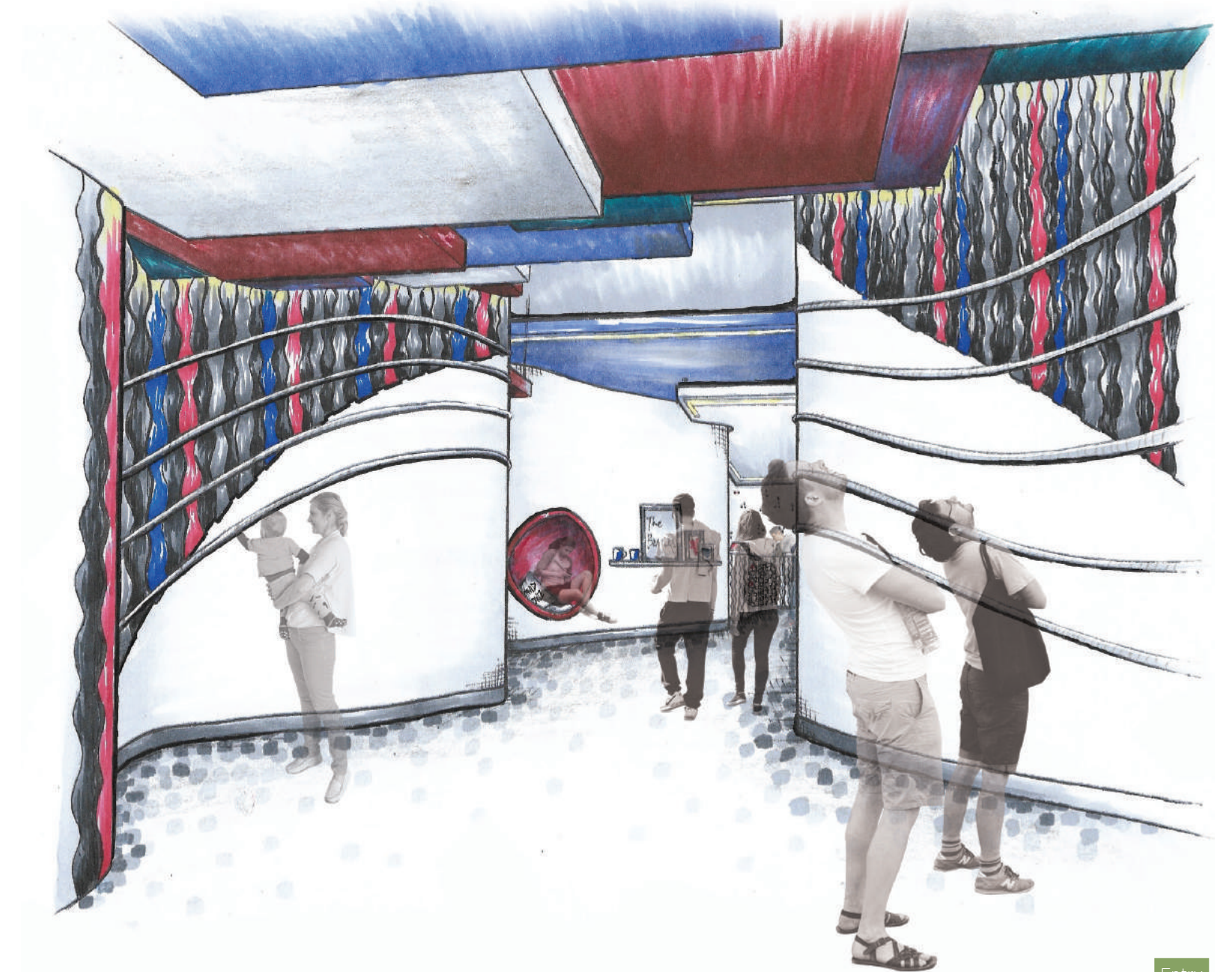
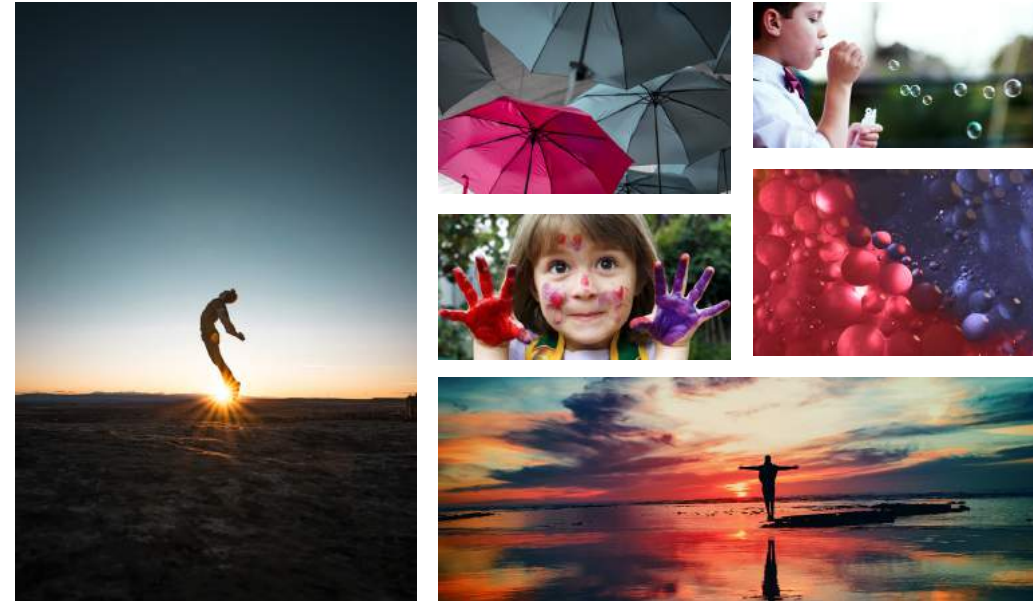

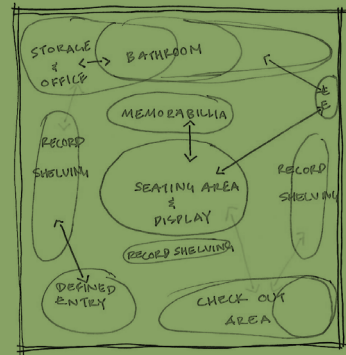

Bubble Diagram

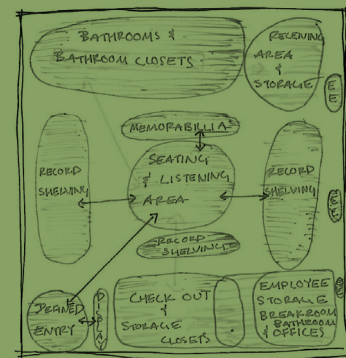

Bubble Diagram



Process Model

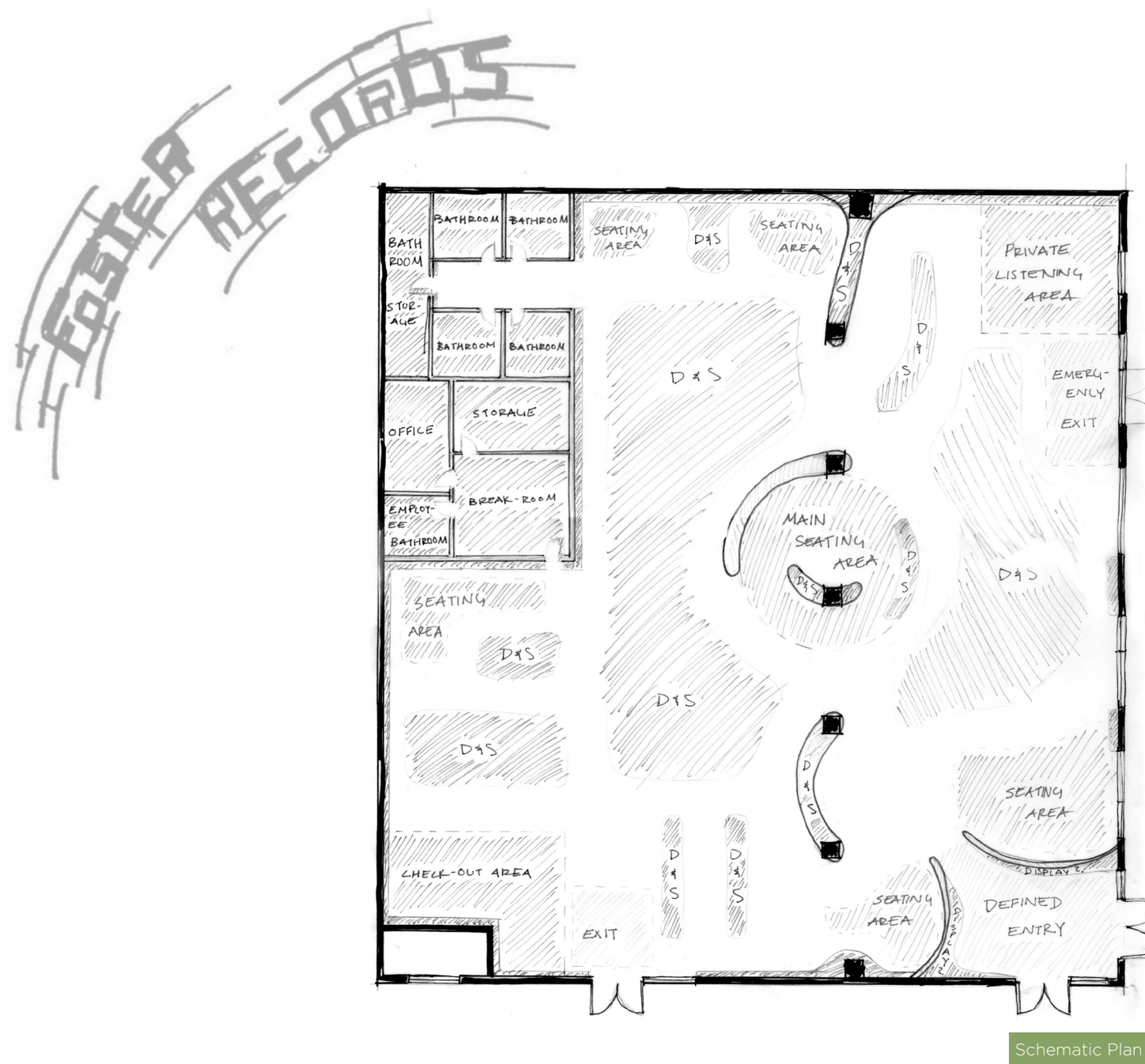

Schematic Plan



Floor Plan

- 1 Restrooms
- 2 Office
- 3 Break Room
- 4 Lounge Spaces
- 5 Record Shelving
- 6 Point of Sale
- 7 Music Lounge
- 8 Merchandise
- 9 Entry



General Seating
Mendi Collection
Architonic



Private Seating
Mendi Collection
Architonic



Casual Seating
4' Bean Bag
Comfy Sacs



Record Players
Ion IT27 Vertical Turntable
B&H Foto

Record Shelves

Plan View

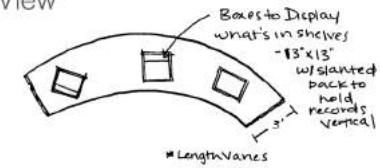

Side View

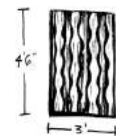

Elevation



3D View

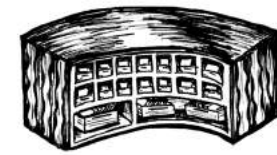

Checkout Counter

Plan View

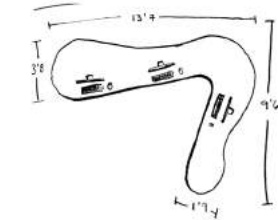

Elevation

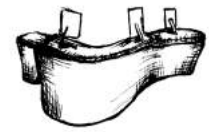
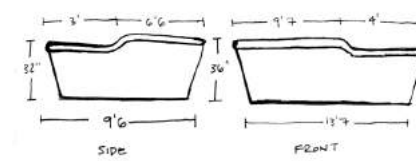

Private Listening Booths

Plan View



Elevation

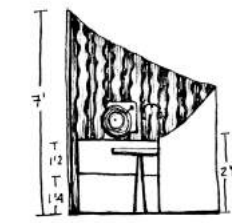

3D View

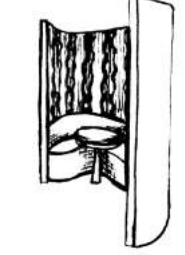

Details

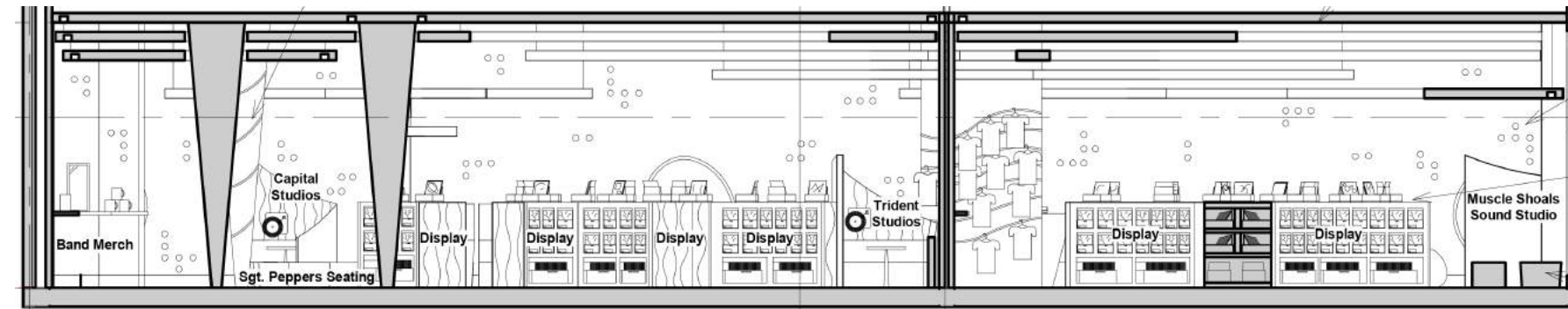

Section

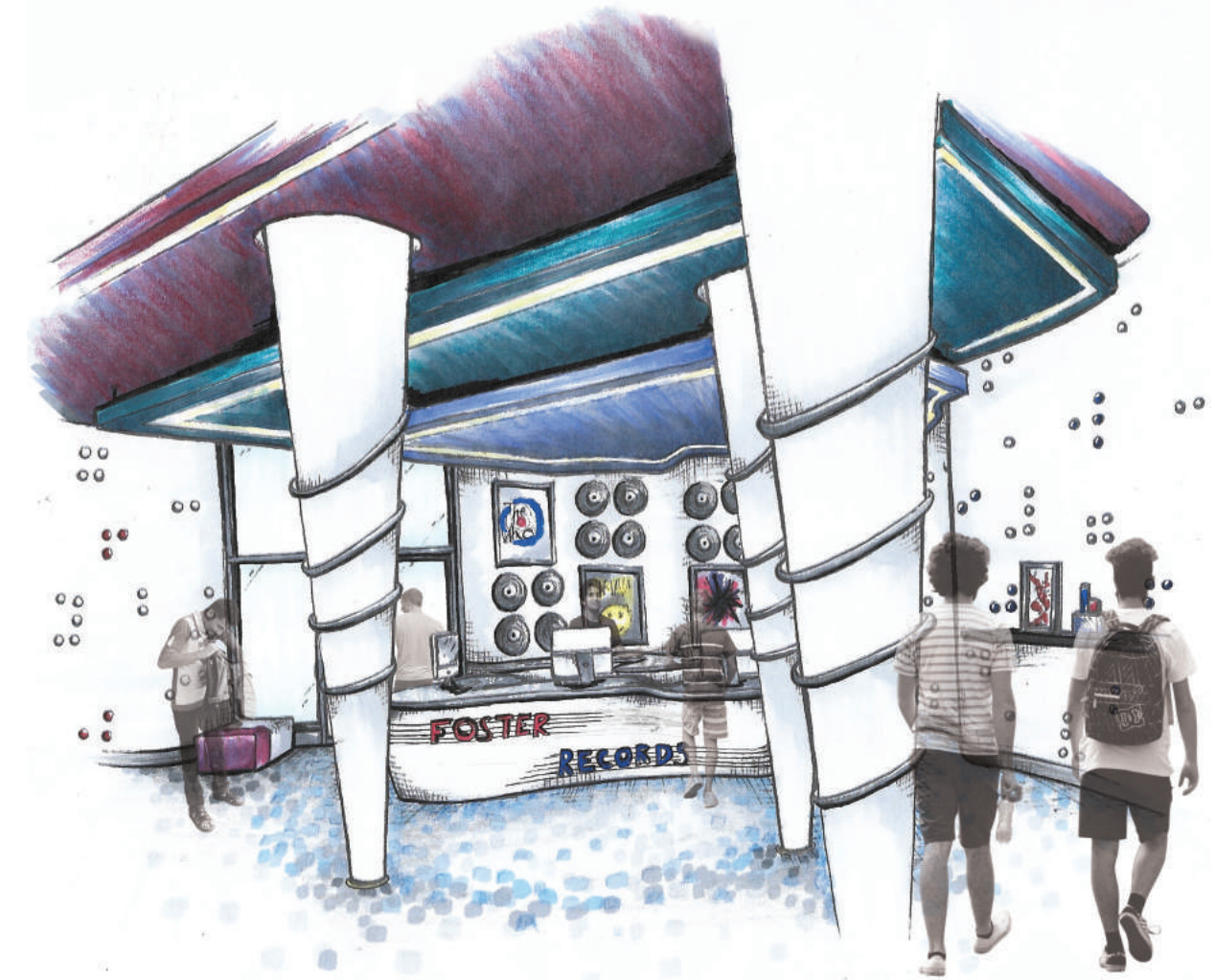

Point of Sale

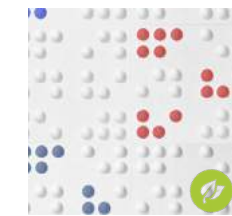

Wallcovering
Braille Wall Flats
Houzz



Point of Sale Counter
Corian
DuPont



Walls and Shelves
Acoustic Panels
Archiproducts



Record Shelves
Oak Slab
Berkshire



Ceiling Panels
Wool Design Felt
Filzfelt

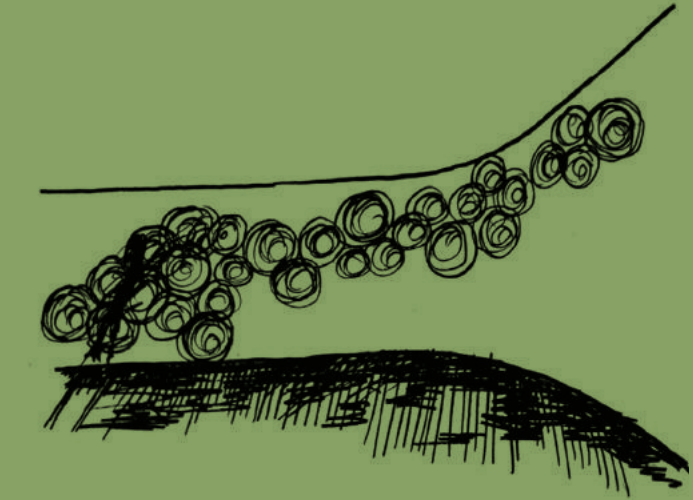

Wall Design Process

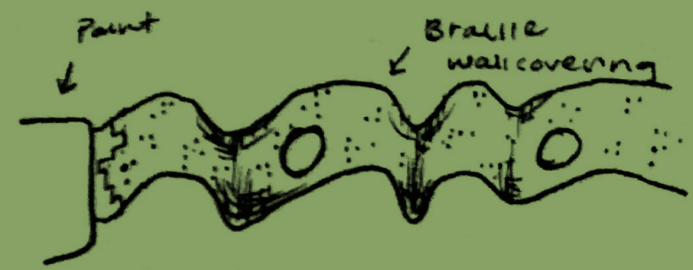

Wall Design Process



Floor Design Process



1/4" Scale Model

Project Inspiration

Foster Records was designed greatly with the clients' **visually-impaired daughter** in mind, in order to give her a place she could enjoy as much as anyone else could. This is done through intuitive wayfinding with wide walkways and minimal sharp corners. There is high contrast in the colors and textures, along with bright lighting. The record and memorabilia areas are labeled with braille and the wallcoverings are large braille dots.

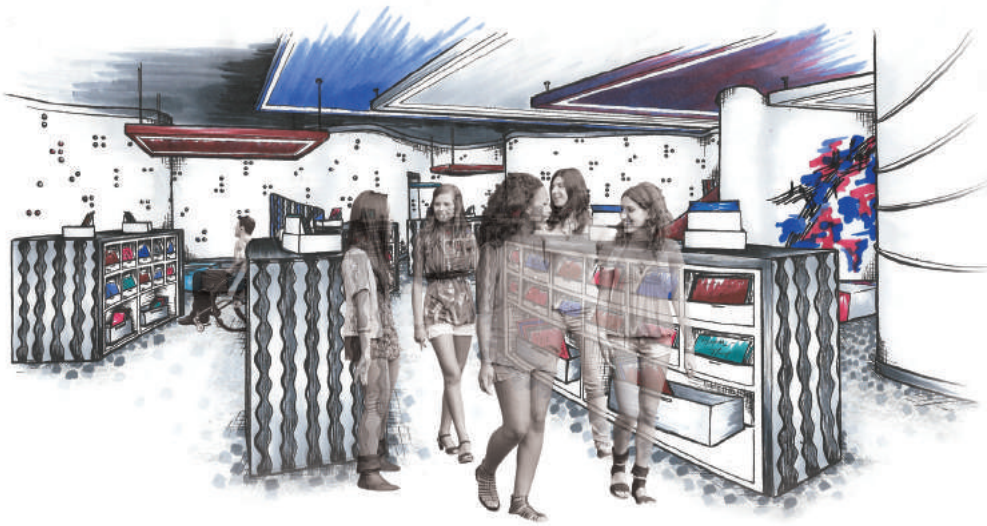

Record Shelving

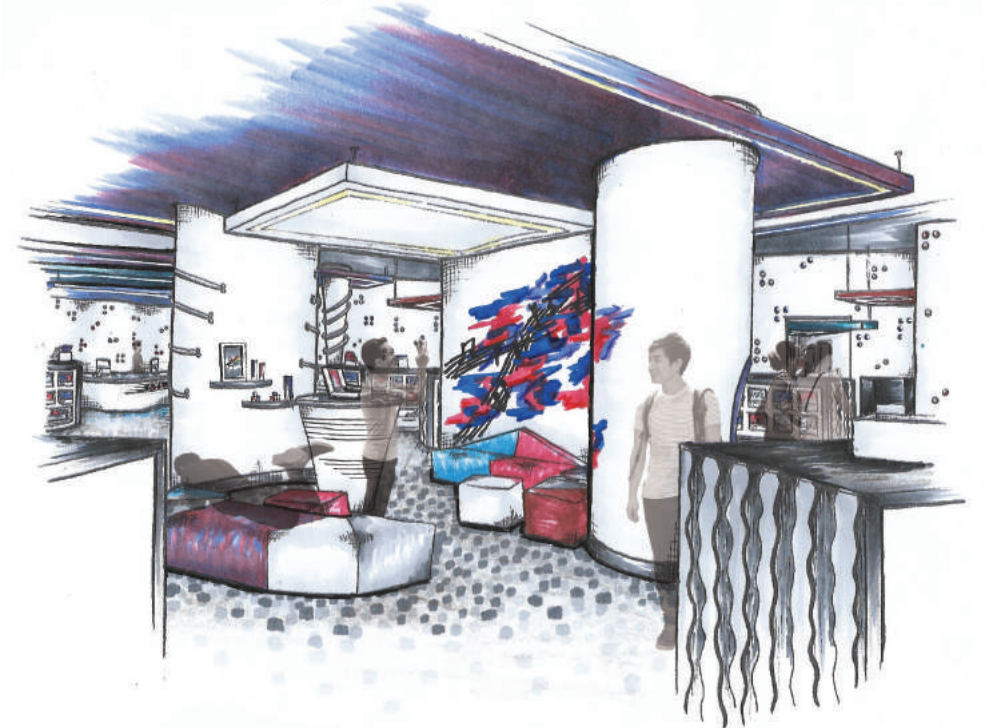

Music Lounge



ADDITIONAL DESIGNS

Digital & Hand Renderings | 3D Models

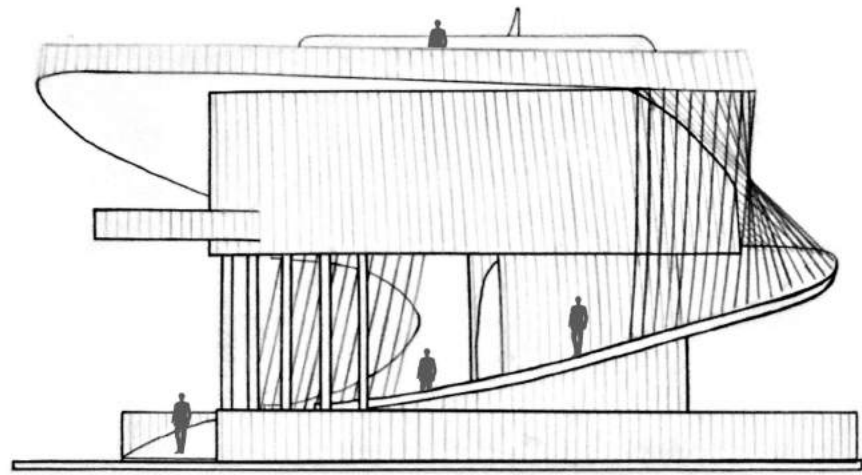

Elevation

60'S MUSIC PAVILION

Abstract Architecture

Project Description

This pavilion design centered around classic 60's music with **organic**, **spherical**, and **elliptical** shapes. People circulate from the ramp on the ground up and around to the top balcony. A **secluded record playing area** allows the sound to travel up through the rest of the pavilion.

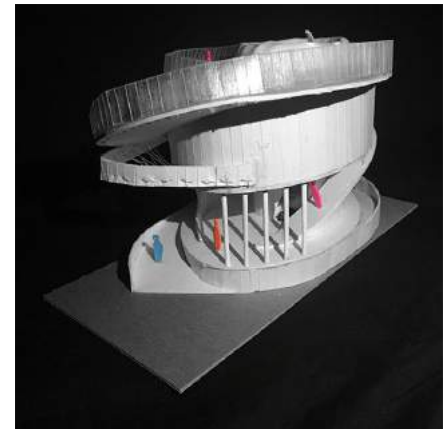
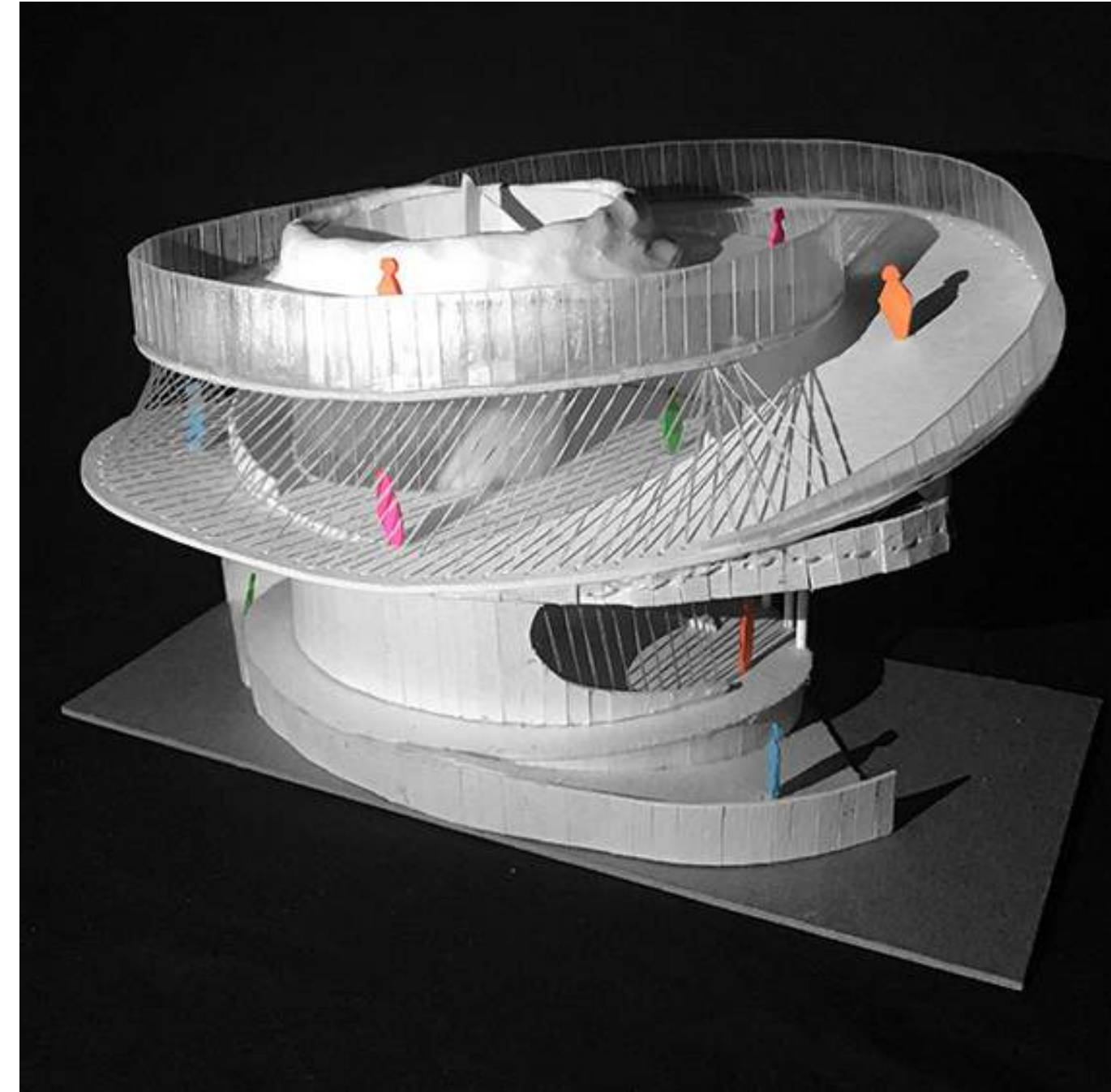

Back Side

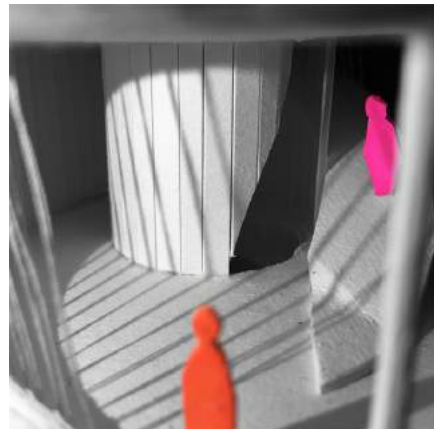

Entry



Top View

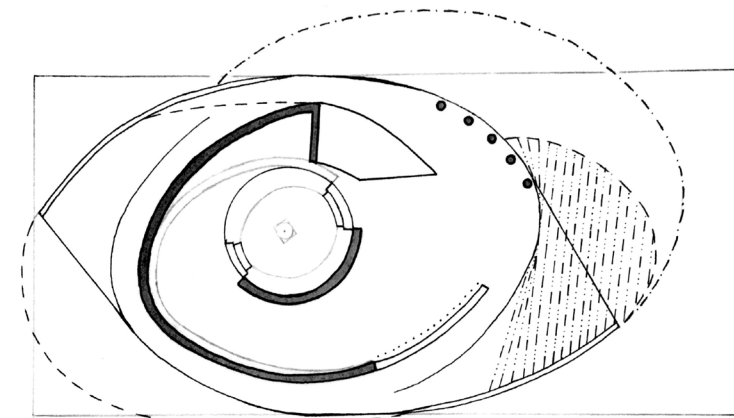

Floor Plan

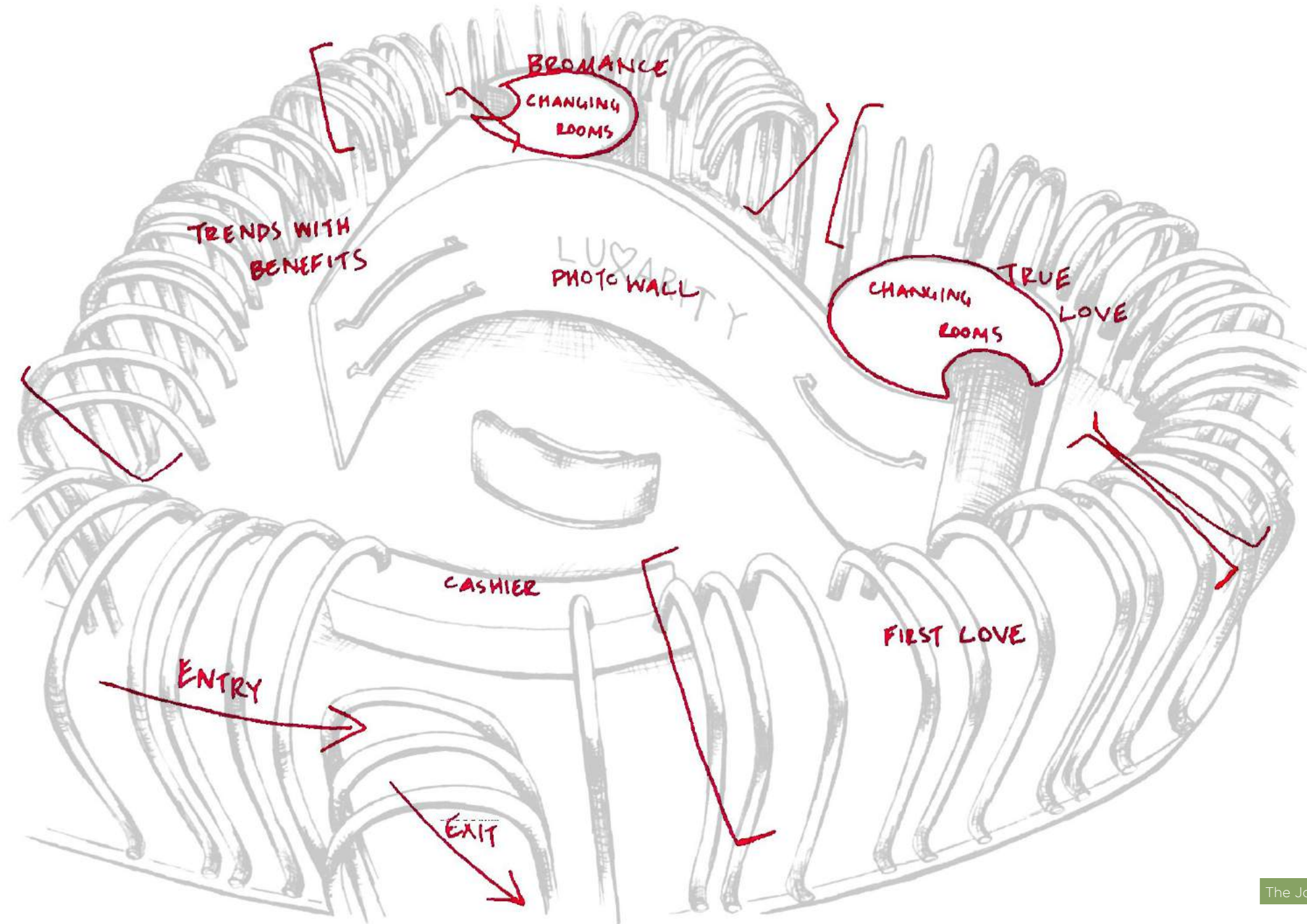

The Journey

LUXARITY POP-UP

Retail Design

Project Description

This design is a pop-up shop for a charity branch of a high-end retail company. My team and I worked with an **advertising team** who provided us with the general concept.

The floor plan for the shop was designed based on the company's logo and each section was designed to fit the specific theme of the section, yet still coherent with the rest of the design. It was designed to have a **clean** and **luxurious** feel while remaining **cost-effective**.

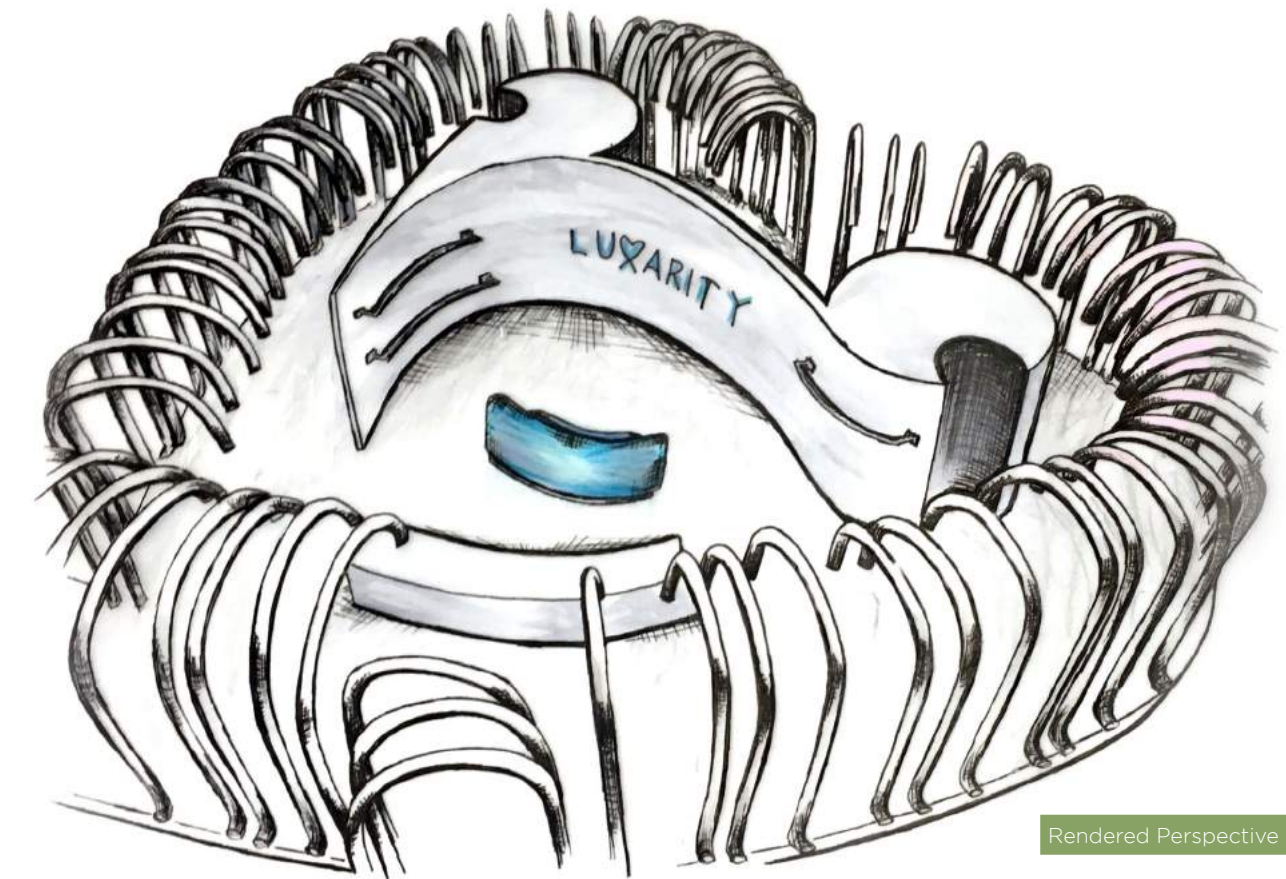

Rendered Perspective

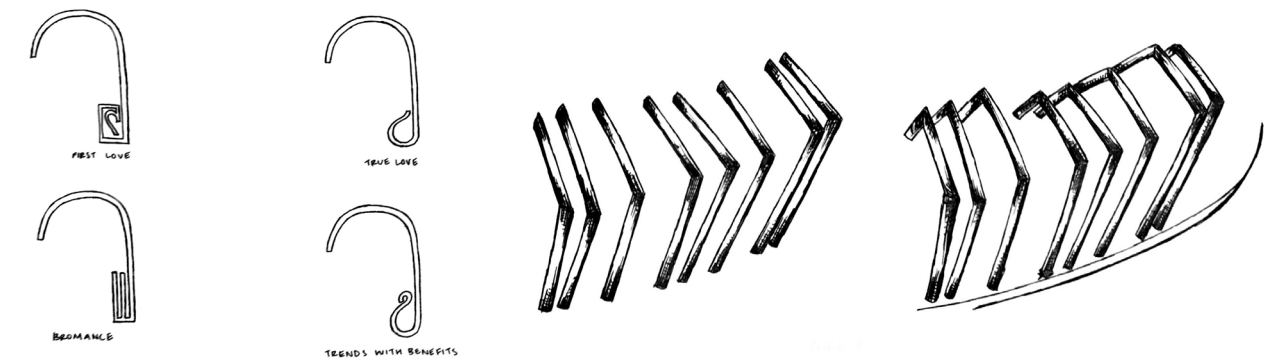

Section Headers

Arch Options



Kitchen

RUSTIC HOME

Residential Design

Project Description

This rustic home was designed to feel **warm and cozy**, with comfortable seating options, such as the corner-booth seating in the kitchen. The **stonework** is carried through both spaces, along with the **exposed timber**, adding to the rustic style. The living room was designed with a large, two-story fireplace and many seating options. The client's **passion** for vinyl is also displayed along the walls in the living room.



Living Room

Email
averyvittoria@gmail.com

Website
www.averyvittoria.com

Phone
952.693.6525

2019



AVERY VITTORIA